

Samsung SmartThings

User manual

Home Automation

From HKT Smart Living

Table of contents:

- 1. About the Samsung SmartThings app2
 - 1.1. Feature overview2
 - 1.2. Download and install the SmartThings app.....5
- 2. Get started with the Samsung SmartThings app.....6
 - 2.1. Create a Samsung account6
 - 2.2. Set up the SmartThings Wifi9
- 3. Add a new smart home device18
 - 3.1. Add a SmartThings motion sensor and Aurora Smart Bulb.....18
 - 3.2. Control the Aurora Smart Bulb and SmartThings motion sensor.....27
- 4. Create a smart home.....28
 - 4.1. Create preset ambience28
 - 4.2. Set up automation32

1. About the Samsung SmartThings app

1.1. Feature Overview

The SmartThings app enables you to control and manage a variety of smart devices and helps you create a smart home by presetting ambient scenes and automating various domestic processes. The SmartThings Wifi also functions as a hub that connects your devices wirelessly and makes them work together.

- The main page covers how to add a variety of devices, set ambient scenes, automating various domestic processes and more. You can also learn about control shortcuts and how to configure a smart home system (Image 1.1.1 & 1.1.2)

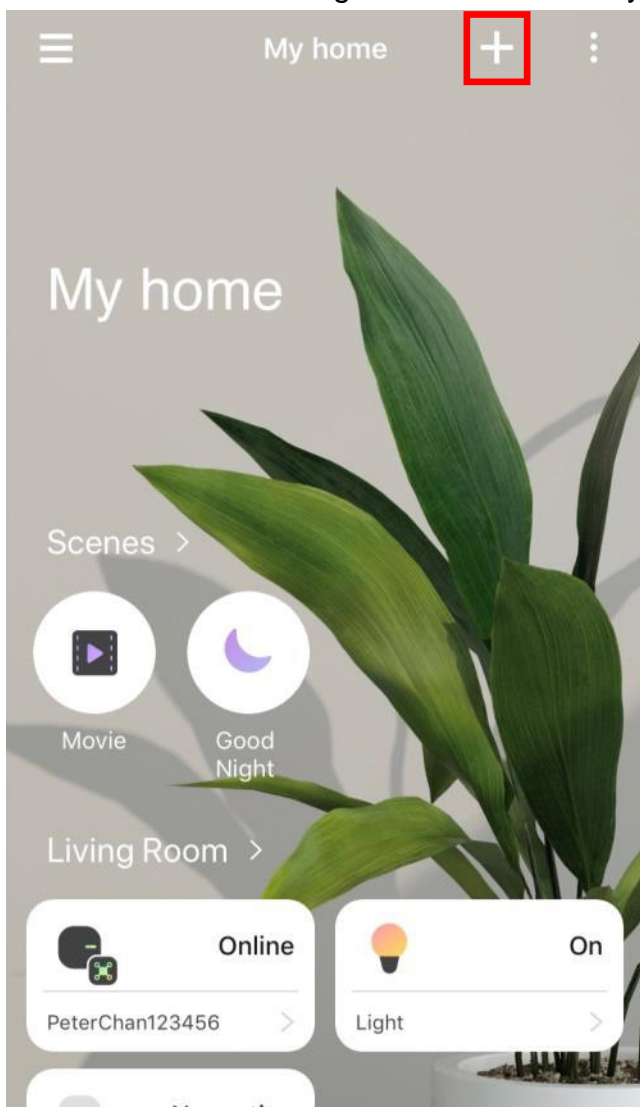

(Image 1.1.1)

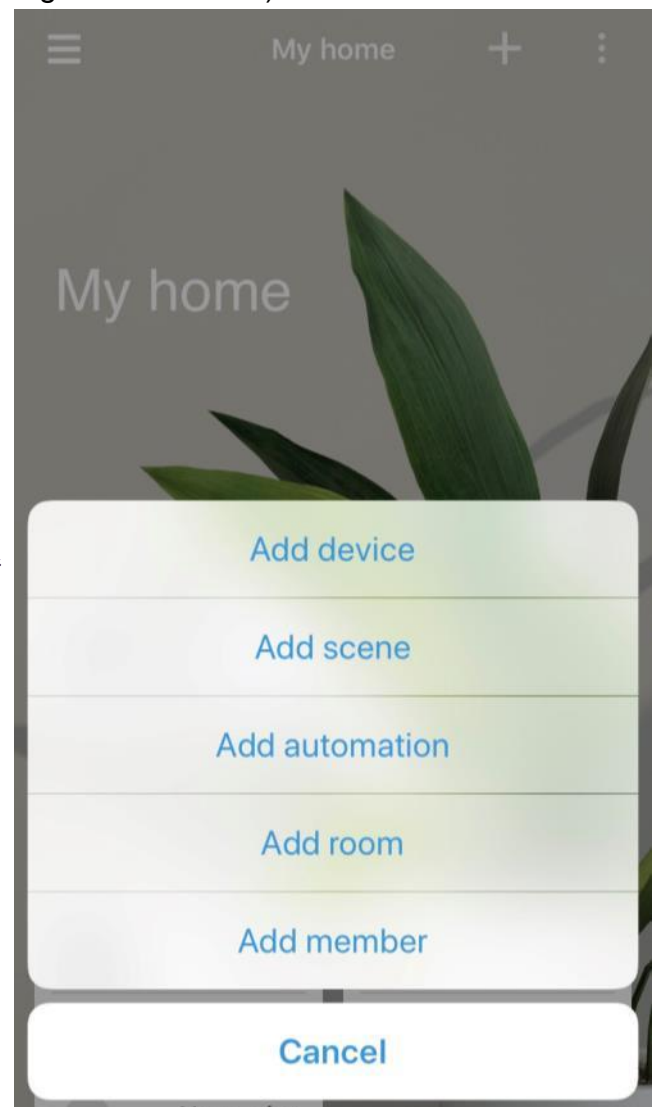

(Image 1.1.2)

- Menu – smart home settings and checking system details (Image 1.1.3).



(Image 1.1.3)

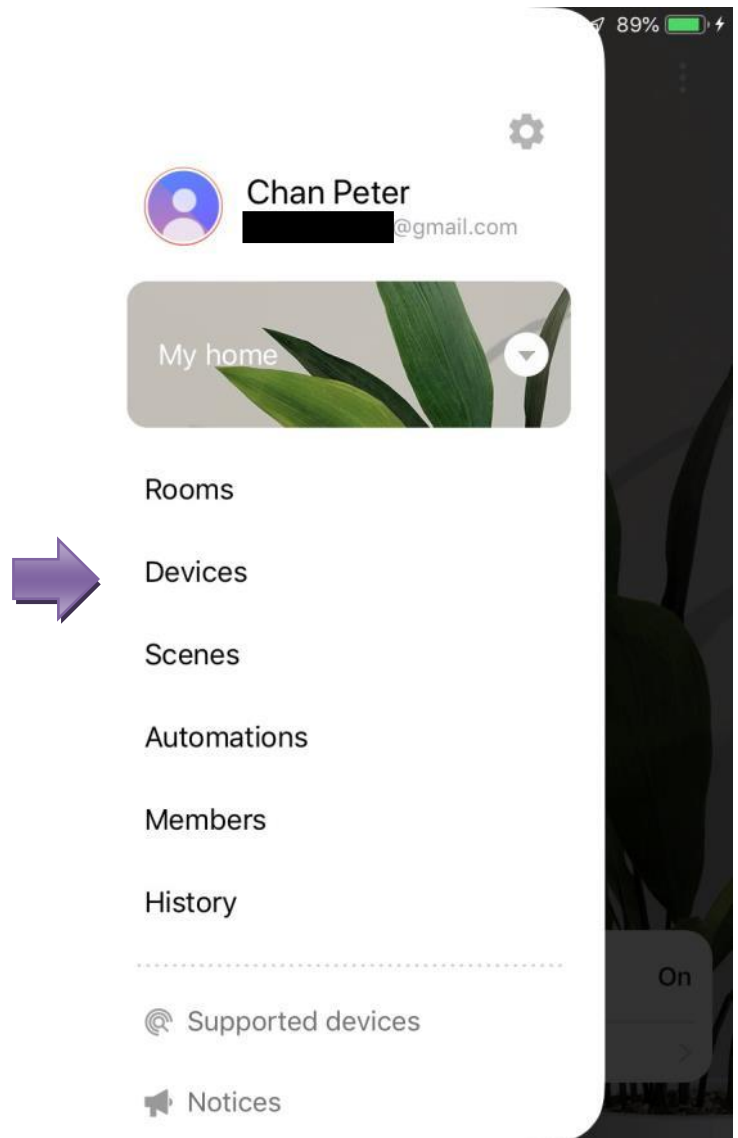

(Image 1.1.4)

Pull-down manual feature list (Image 1.1.4):

1. **Location** – user can install a SmartThings system in different locations – such as an office or second home – but manage all systems from a single app
2. **Rooms** – user can segregate specific rooms in order to manage devices and appliances separately in each.
3. **Devices** – all connected devices are displayed and the user can control or check status of each device. Frequently-used devices can be displayed on the main page for easy control
4. **Scenes** – a number of smart devices can be set to turn on/off simultaneously by clicking an icon in the app, via a voice command or by automation
5. **Automation** – SmartThings enables devices or ambient scenes to be activated automatically when certain criteria are met

6. **Members** – this is to facilitate account management. The user can invite others to connect their devices to a household's SmartThings Wifi. The user can send invitations to Samsung accounts or scan QR codes. Invitees need to register for a Samsung account in order to log into the app
7. **History** – user can check the system log (notification and control log) to view records over the last seven days

1.2. Download and install the SmartThings app

The SmartThings app is compatible with iOS (version 8.x or newer) and Android (version 6.x or newer) in multiple languages:

- Go to the Apple App Store or Google Play Store
- Search for “SmartThings”
- Install the SmartThings app provided by Samsung Electronics Co Ltd (Image 1.2.1 & 1.2.2)
- Run the app and start the setting up procedure

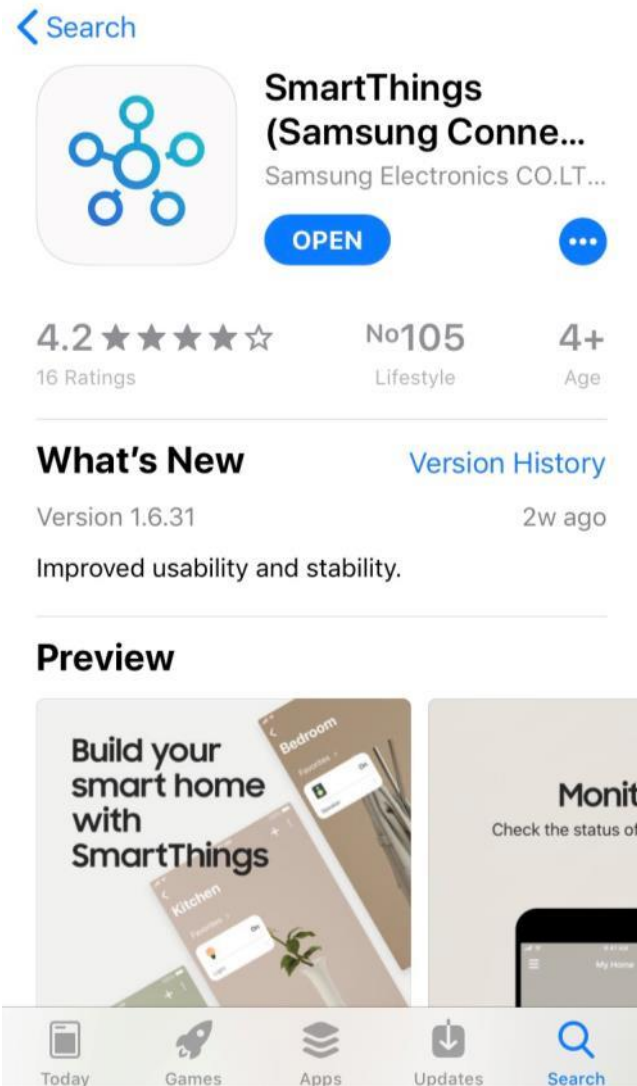

(Image 1.2.1)

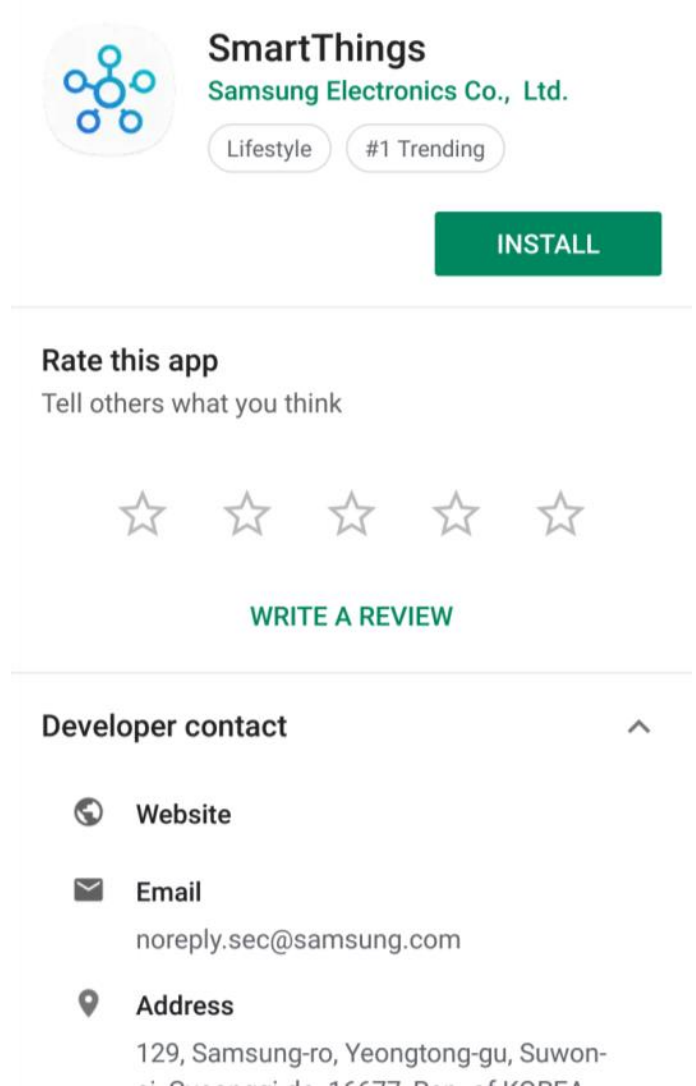

(Image 1.2.2)

2. Get started with the Samsung SmartThings app

Using the SmartThings app requires you to register for a Samsung account:

- Create a Samsung account by going to section 2.1 (your email address is required when registering for a Samsung account)
- Go to section 2.2 and 3 to learn the basics of setting up the app

2.1. Create a Samsung account

Connect your mobile devices to your mobile network.

- Run the SmartThings app
- Select “Sign in” (Image 2.1.1)
- Select “CREATE ACCOUNT” (Image 2.1.2)



(Image 2.1.1)

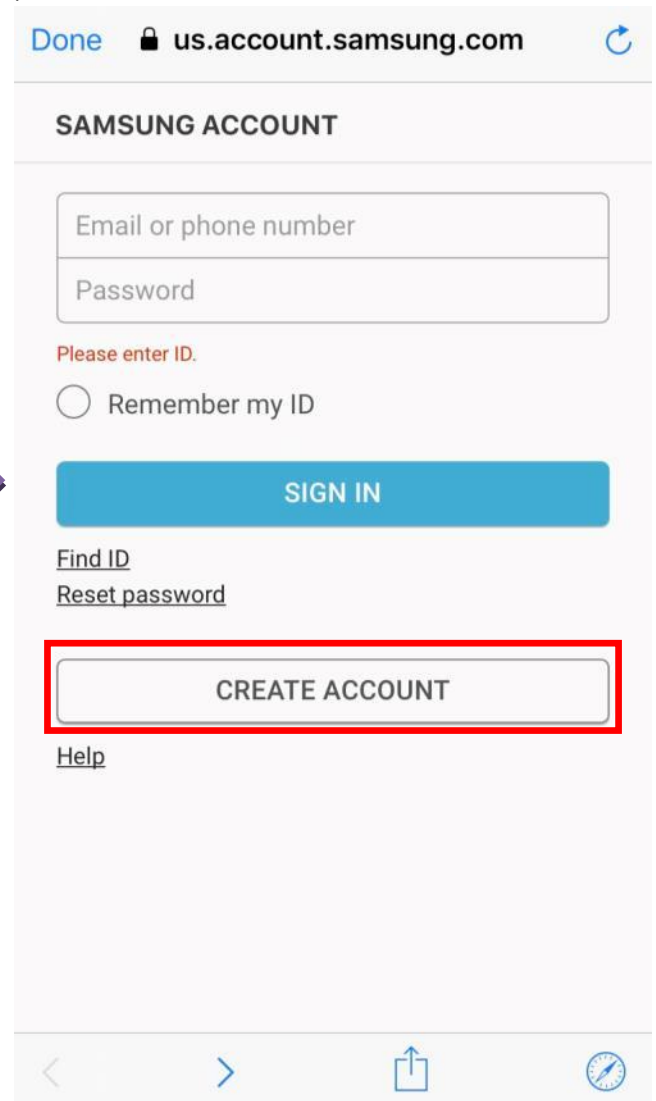

(Image 2.1.2)

- Select “✓” to agree to the Terms & Conditions, then select “AGREE” (Image 2.1.3)
- Complete all fields in this page and click “I’m not a robot”, then select “NEXT” (Image 2.1.4)

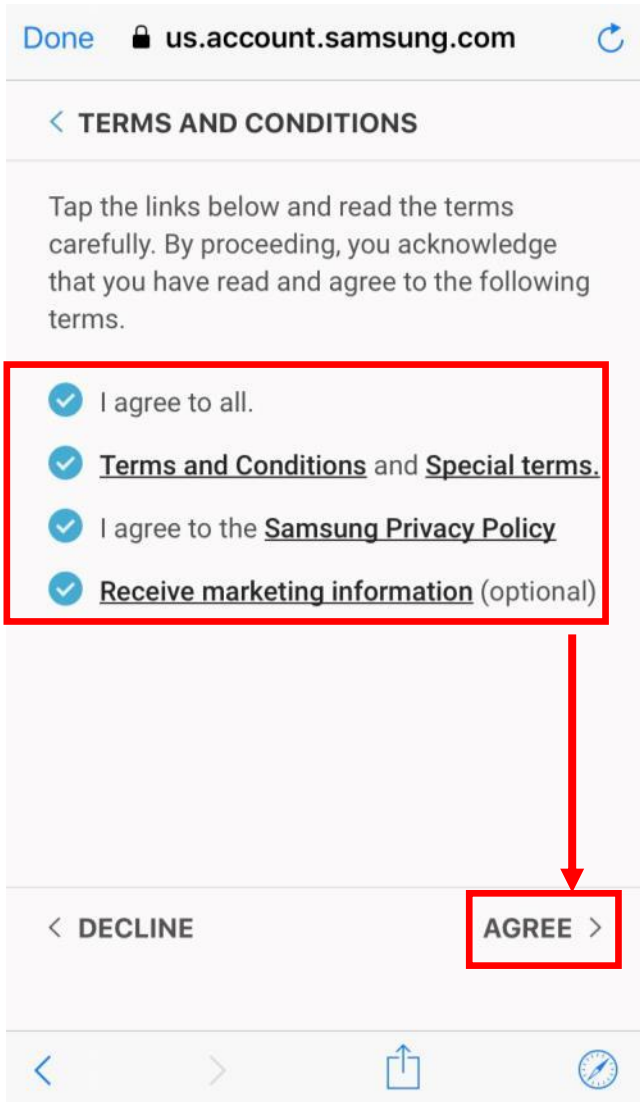

(Image 2.1.3)

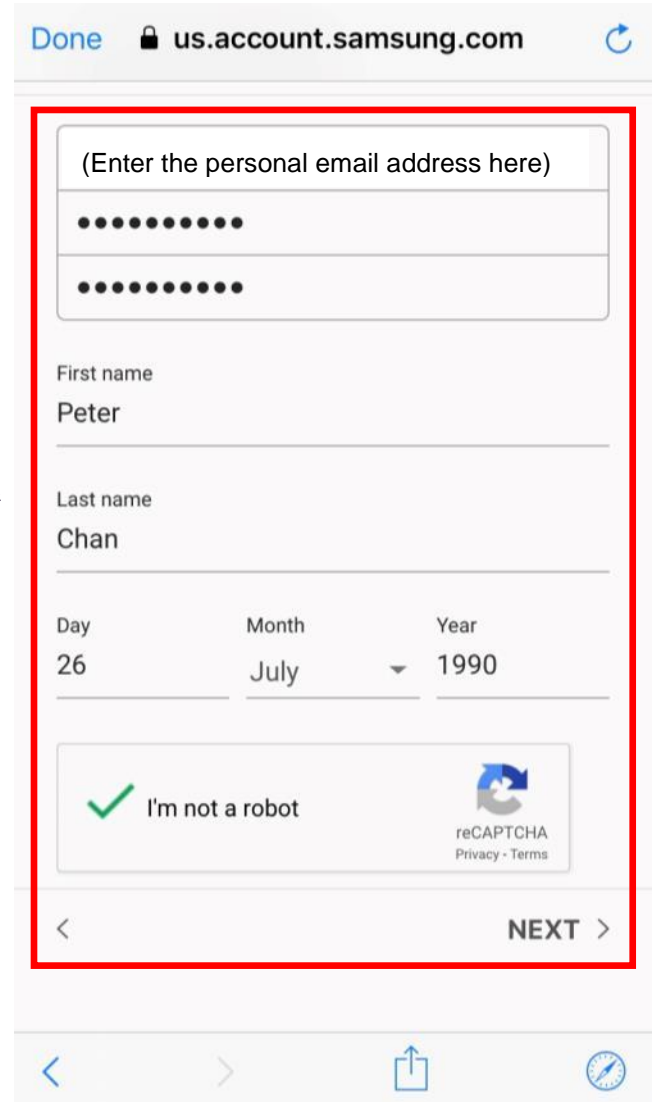

(Image 2.1.4)

- You will receive an email from Samsung to confirm you have created an account (Image 2.1.5)
- Select “VERIFY ACCOUNT” in the email (Image 2.1.6)

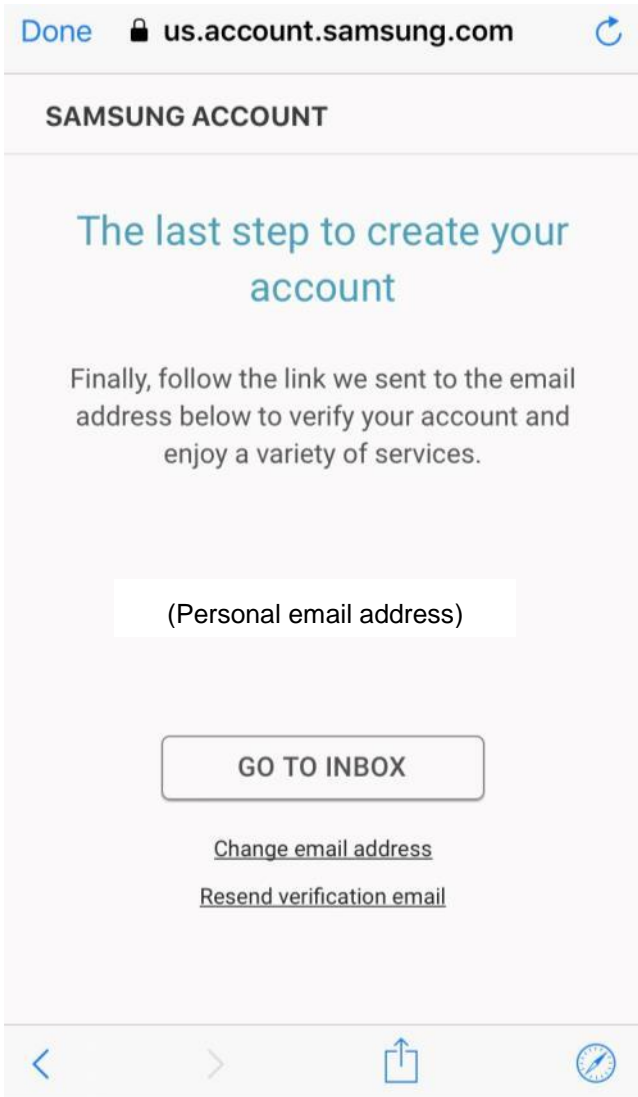

(Image 2.1.5)

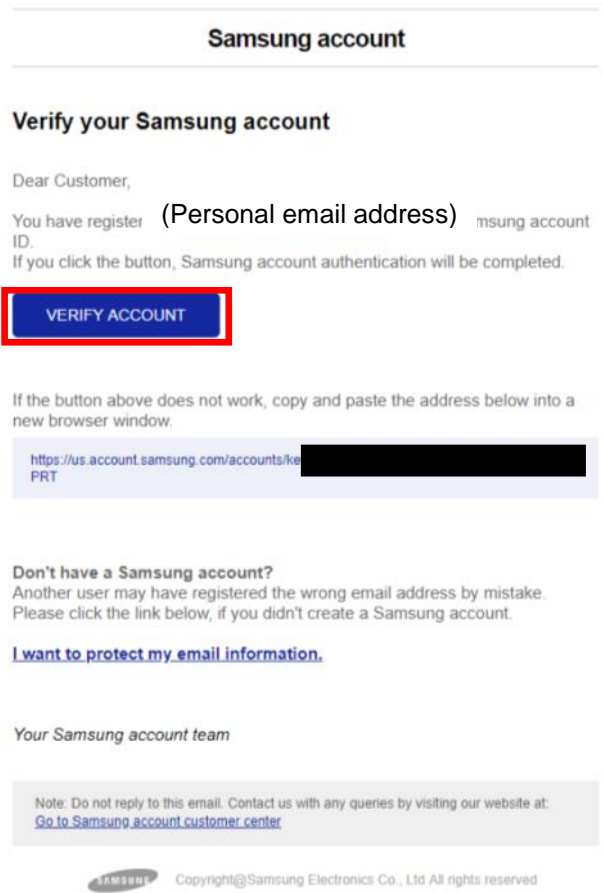

(Image 2.1.6)

2.2. Set up the SmartThings Wifi

Please stay within at 4.5 meters of the SmartThings Wifi.

- Run the SmartThings app
- Enter your email address and password, then press “SIGN IN” (Image 2.2.1)

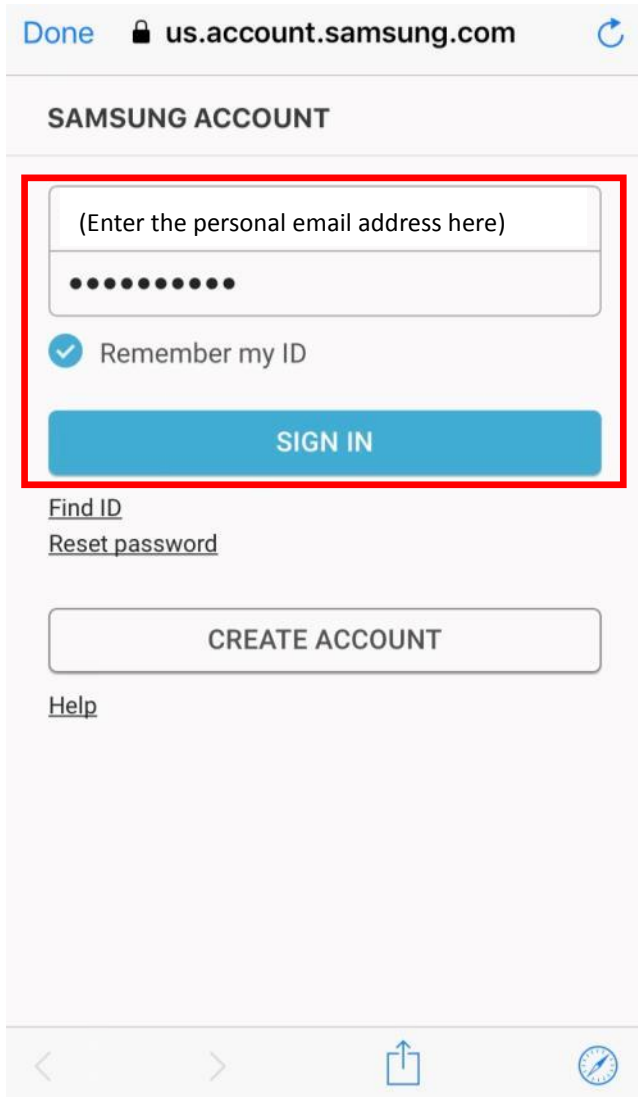

(Image 2.2.1)

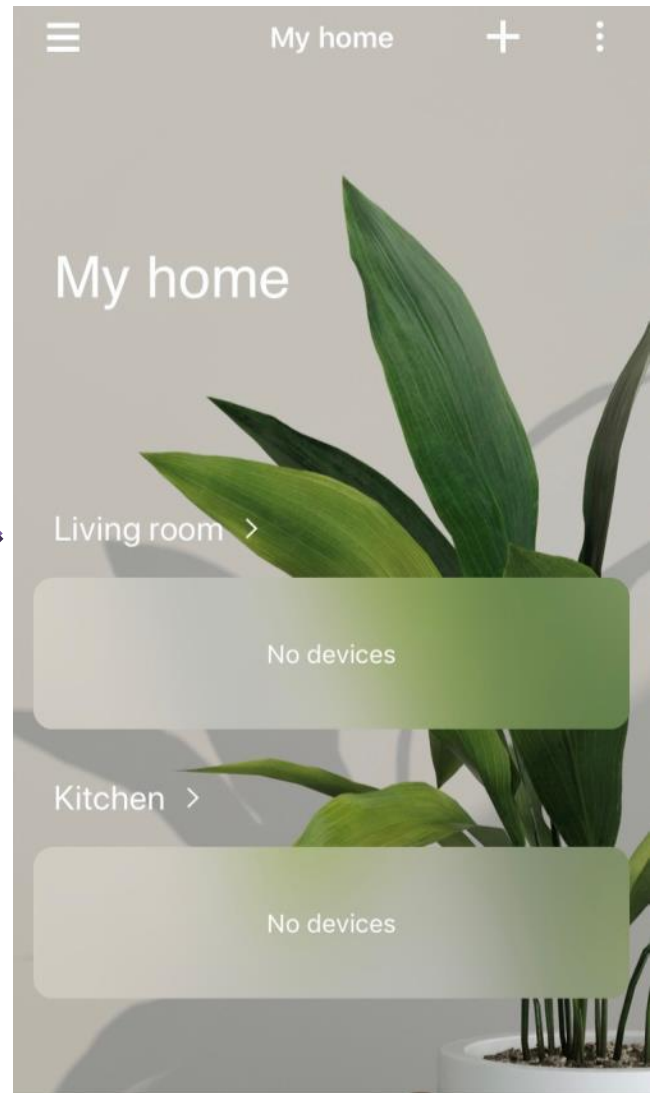

(Image 2.2.2)

- Press “+” then “Add device” (Image 2.2.3)
- Select “SmartThings” under “All Brands” (Image 2.2.4)

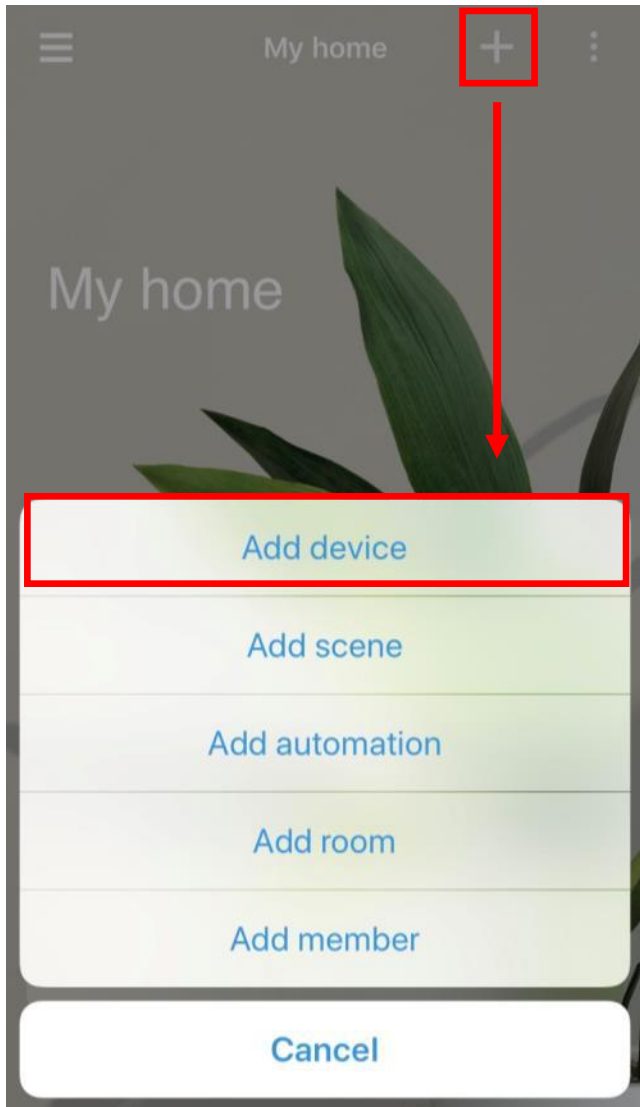

(Image 2.2.3)

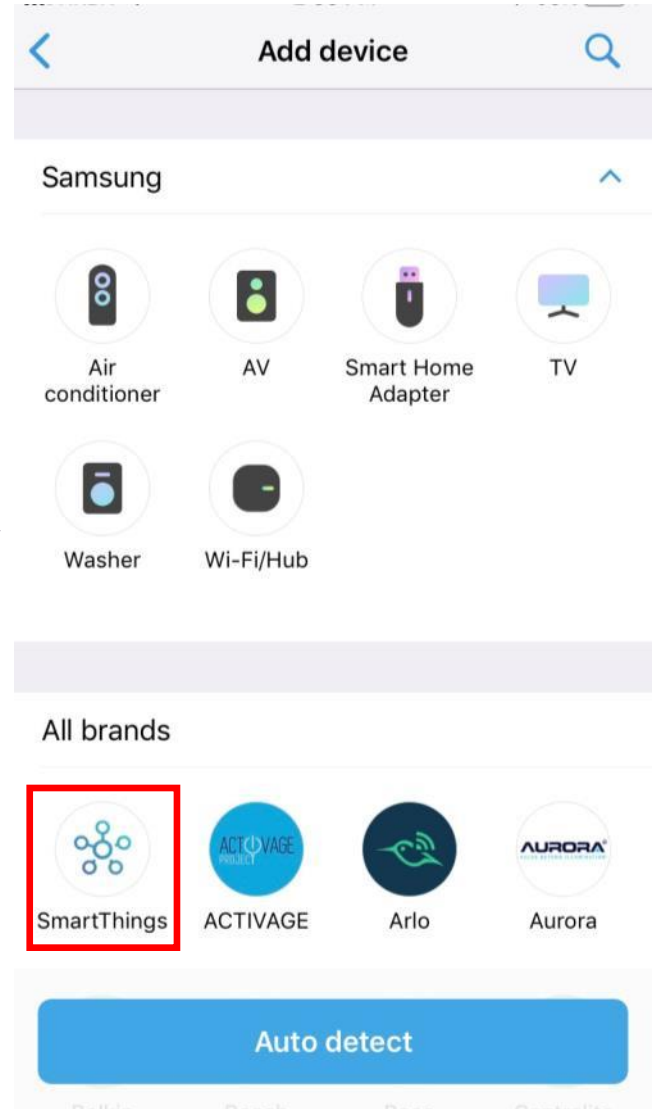

(Image 2.2.4)

- Select “Wi-Fi/hub” (Image 2.2.5)
- Make sure your mobile device’s Bluetooth function is turned on, then select “OK” (Image 2.2.6)

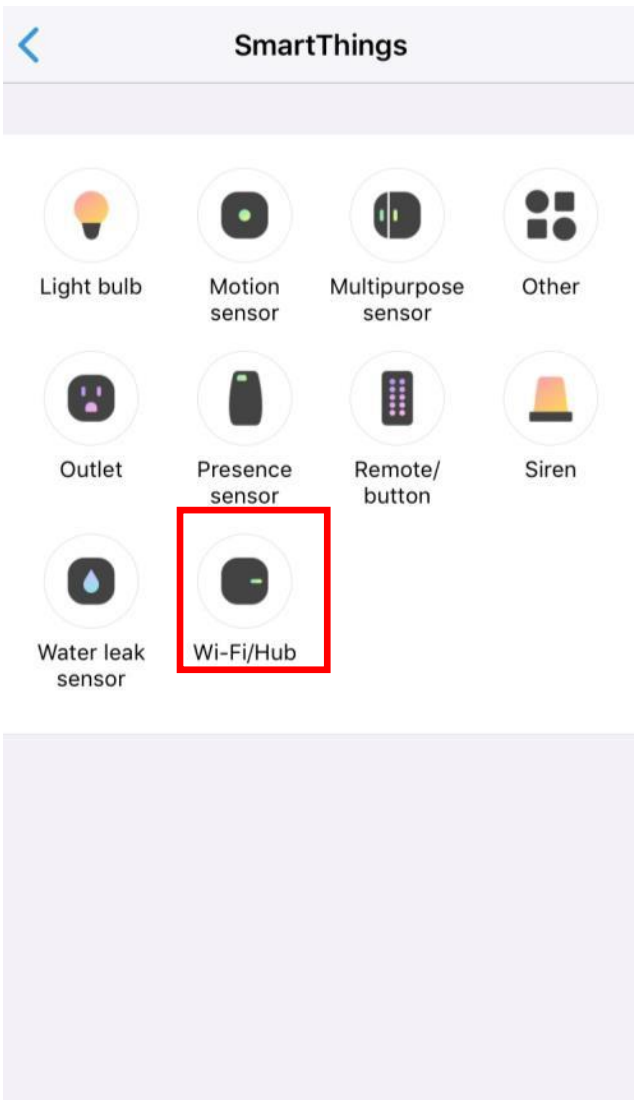

(Image 2.2.5)

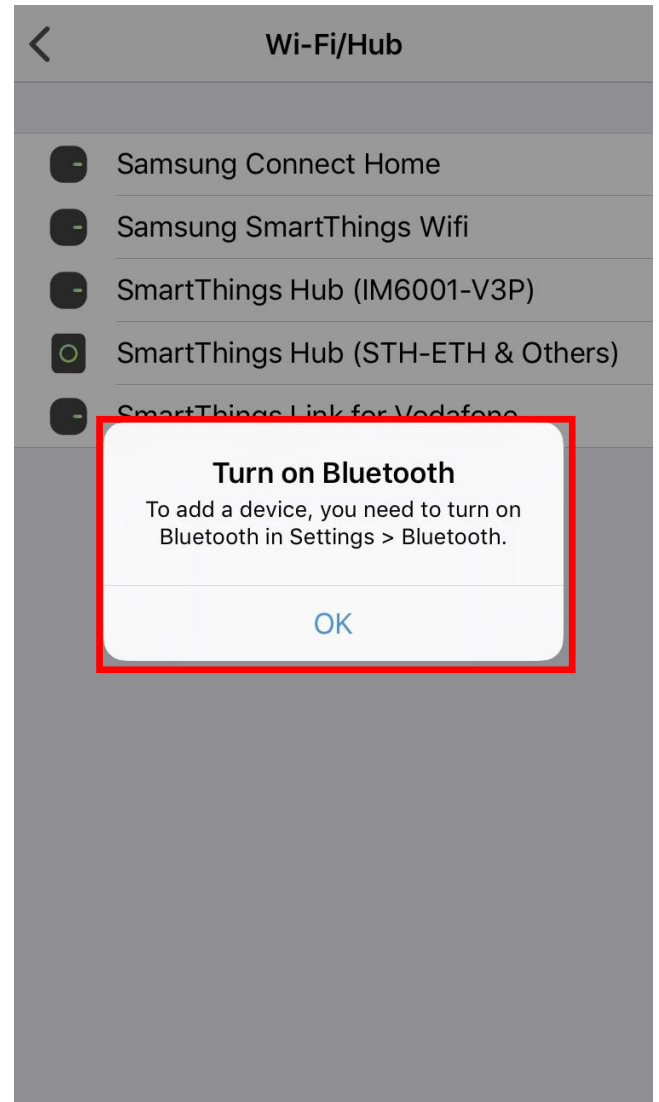

(Image 2.2.6)

- Turn on your mobile device's Bluetooth function (Image 2.2.7)
- Select "Samsung SmartThings Wifi" (Image 2.2.8)

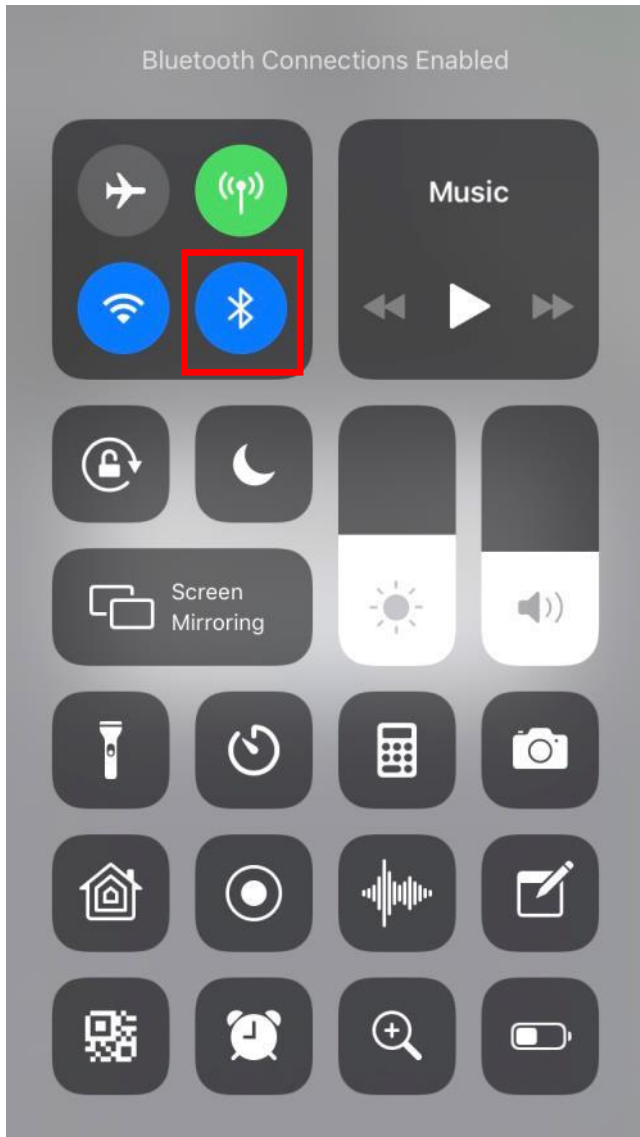

(Image 2.2.7)

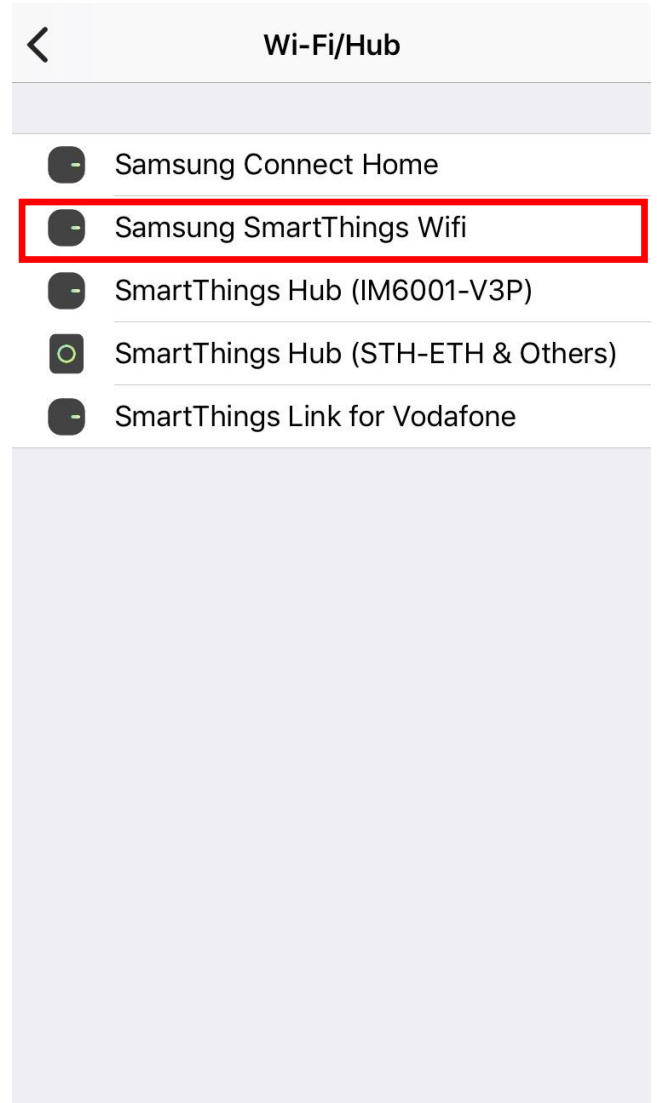

(Image 2.2.8)

- Select “Start”. (Image 2.2.9)
- Select “Set up new Wi-Fi network” and “OK”. (Image 2.2.10)

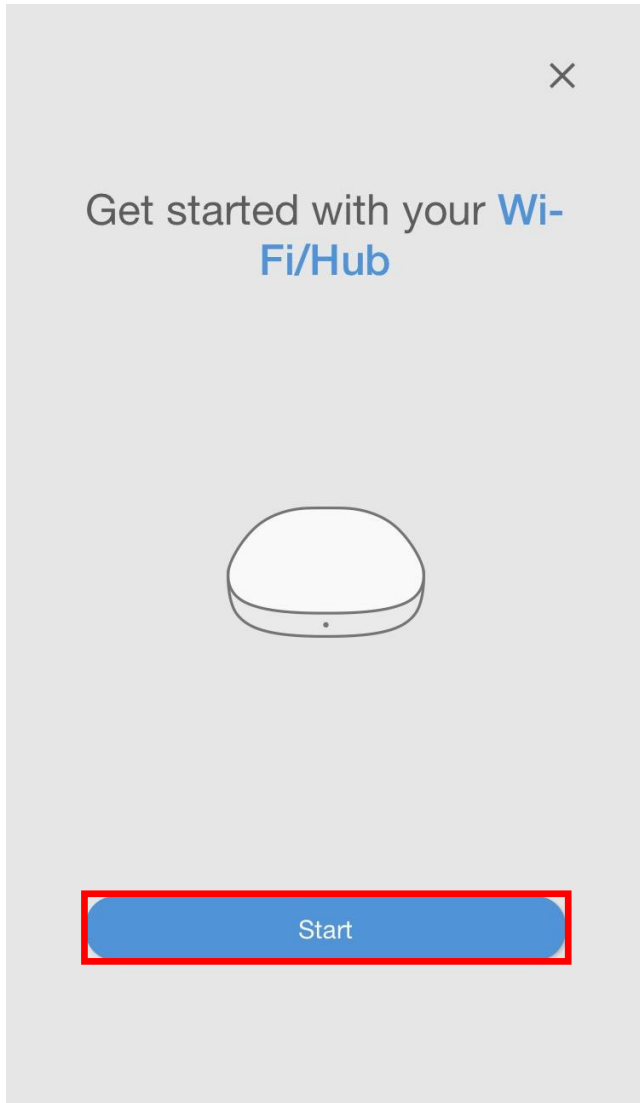

(Image 2.2.9)

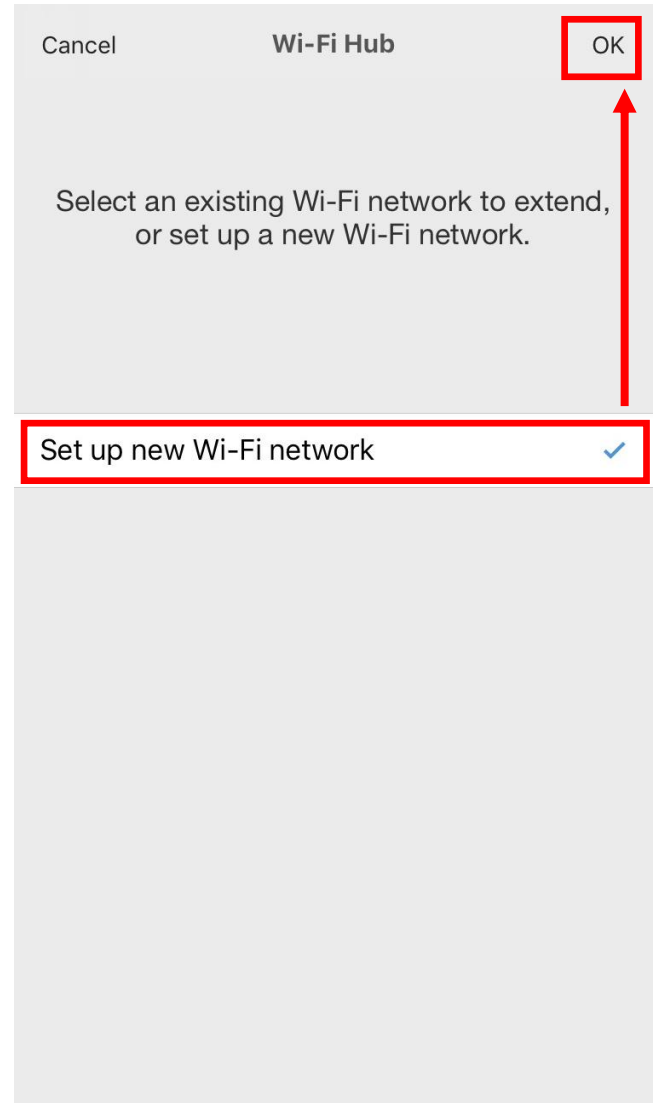

(Image 2.2.10)

- Select location of the SmartThings Wifi, then select “NEXT” (Image 2.2.11)
- Select the room in which the SmartThings Wifi is situated, then select “NEXT” (Image 2.2.12)

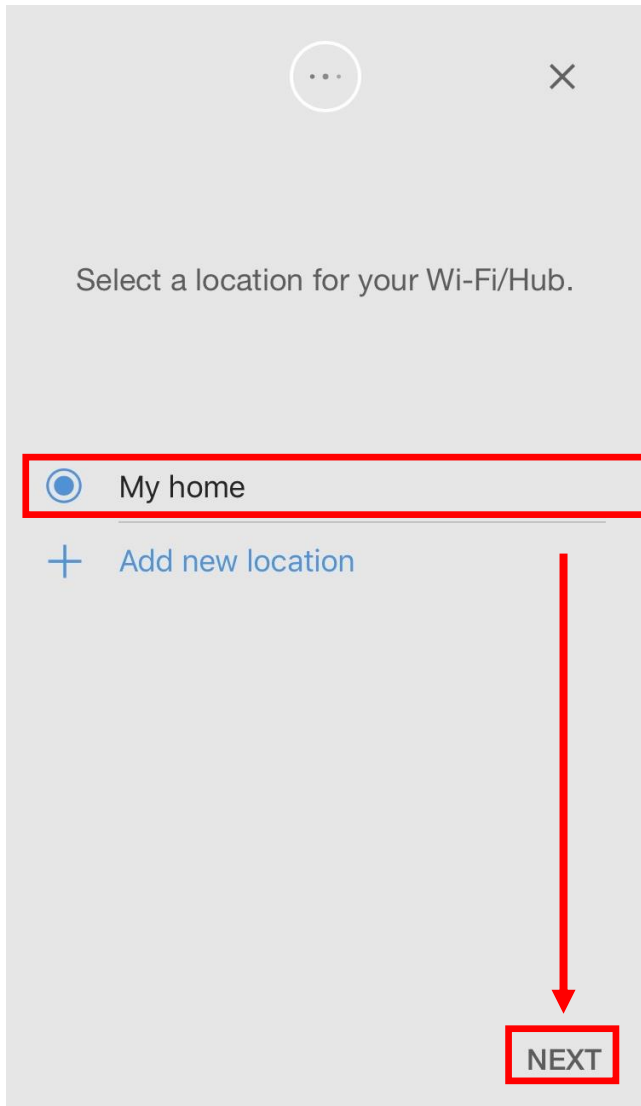

(Image 2.2.11)

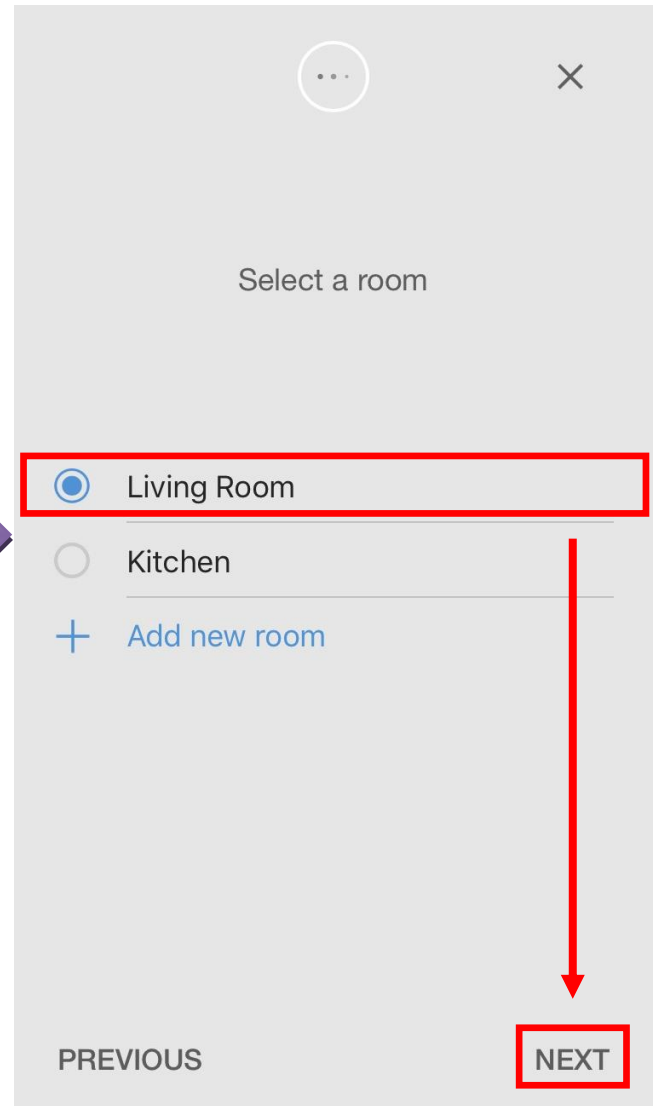

(Image 2.2.12)

- Make sure the SmartThings Wifi is connected to your modem via a LAN cable, then select “NEXT” (Image 2.2.13)
- Make sure the SmartThings Wifi is connected to a power supply, then select “NEXT” (Image 2.2.14)

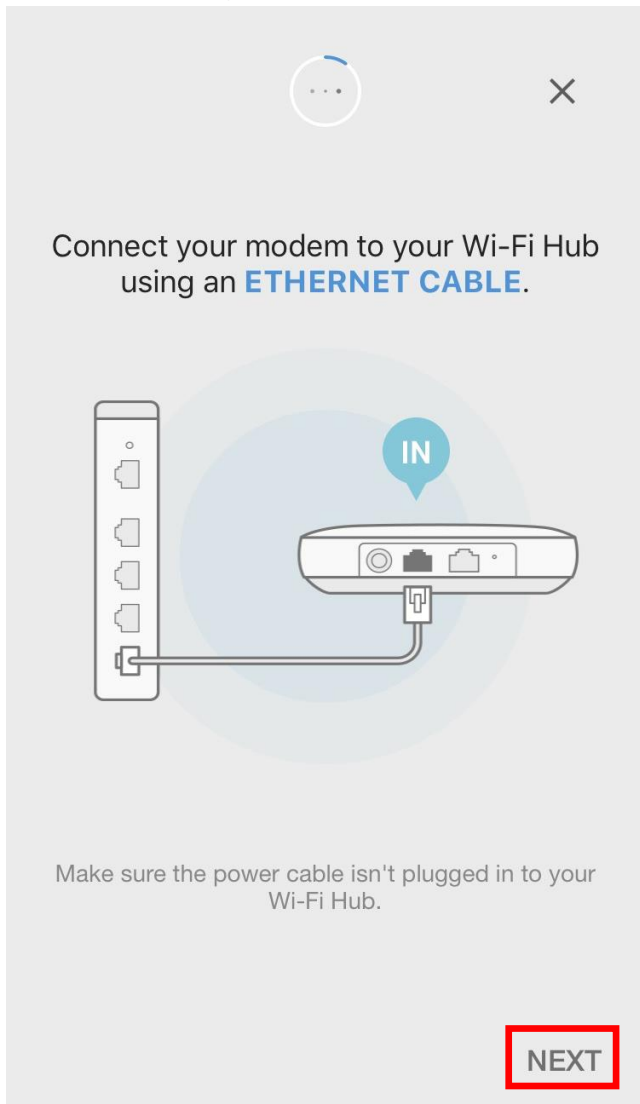

(Image 2.2.13)

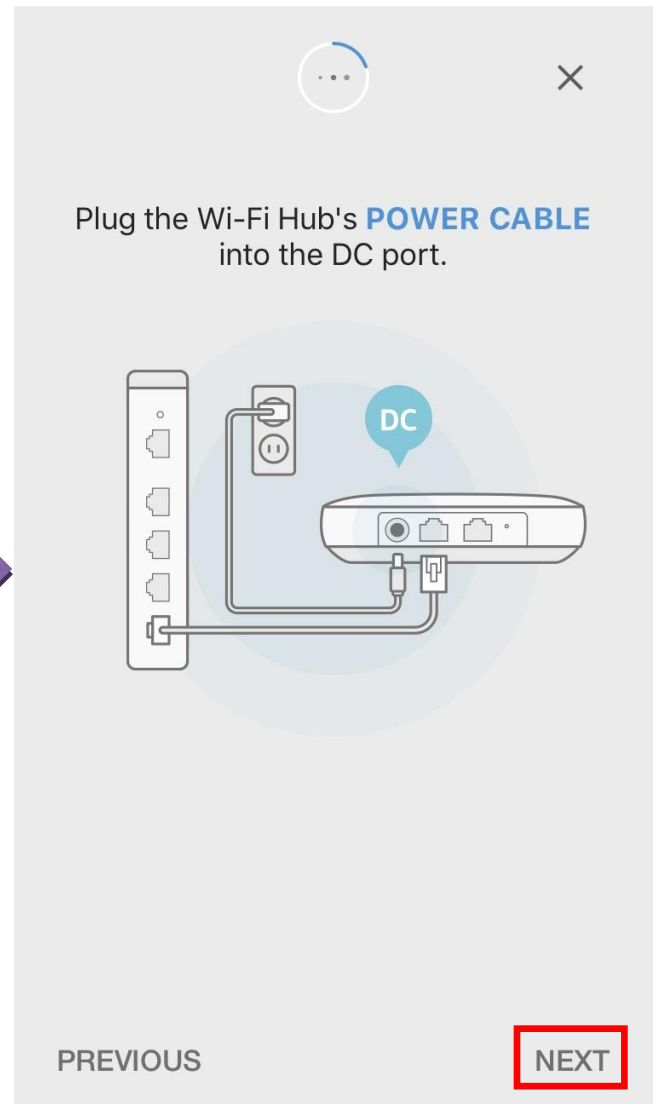

(Image 2.2.14)

- When the indication light at the front of the hub (Wi-Fi router) flashes red and green, select “NEXT” (Image 2.2.15)
- Wait until the app finds the hub (Wi-Fi router), Enter the name of your Wi-Fi network (SSID) and password. Select “✓” to set up the SmartThings Wifi, then select “NEXT” (Image 2.2.16)

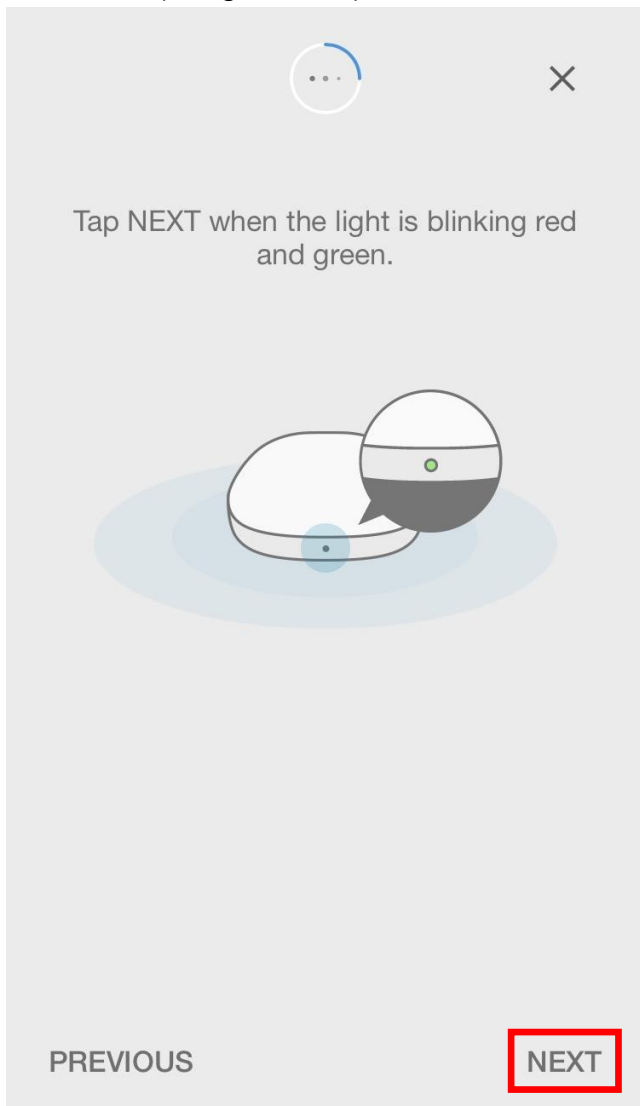

(Image 2.2.15)

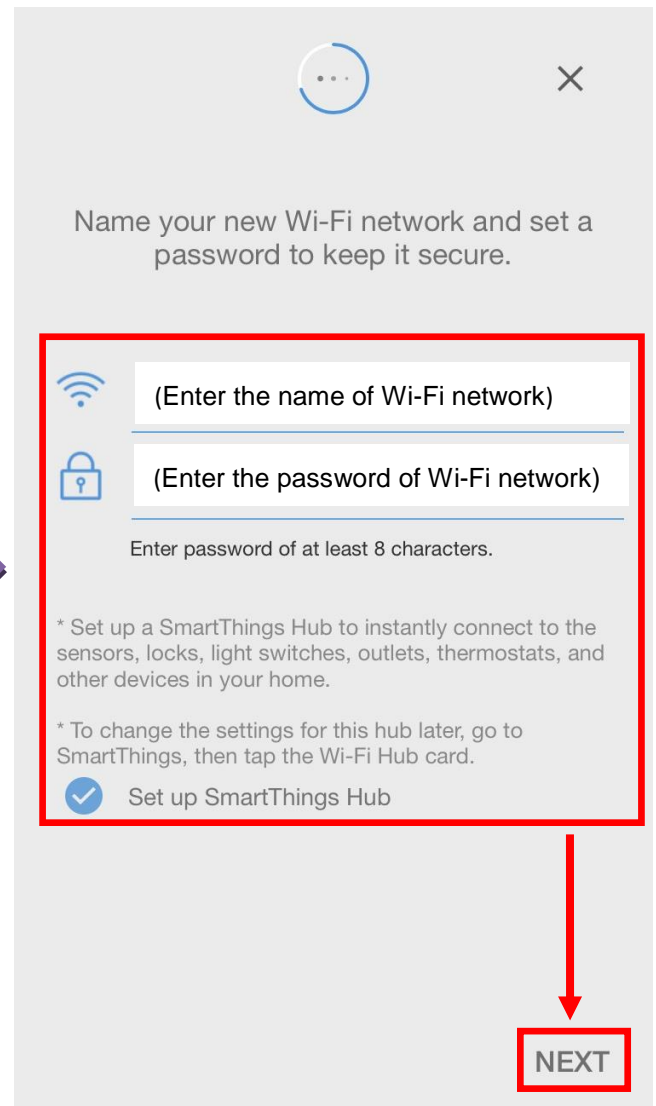

(Image 2.2.16)

- The setup of SmartThings Wifi Hub is completed. User may connect a mobile device to the SmartThings Wifi, or Select “OK” and “Done” and go to next section (Image 2.2.17)
- Select “Hub Name” to change the name of the device, or Select “Done” to complete the setting. (Image 2.2.18)

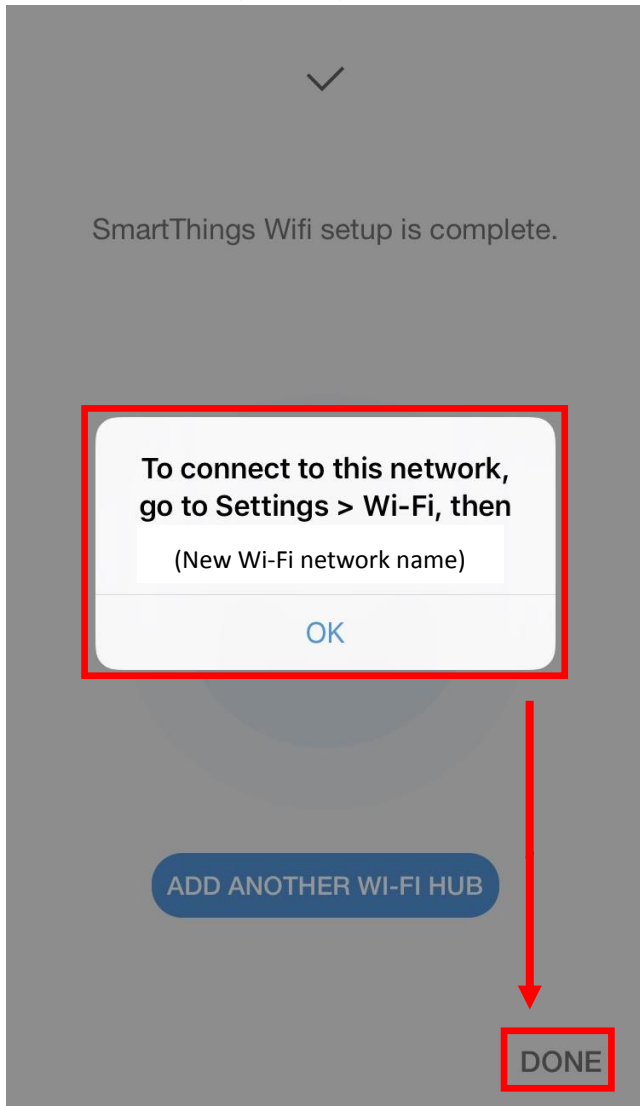

(Image 2.2.17)

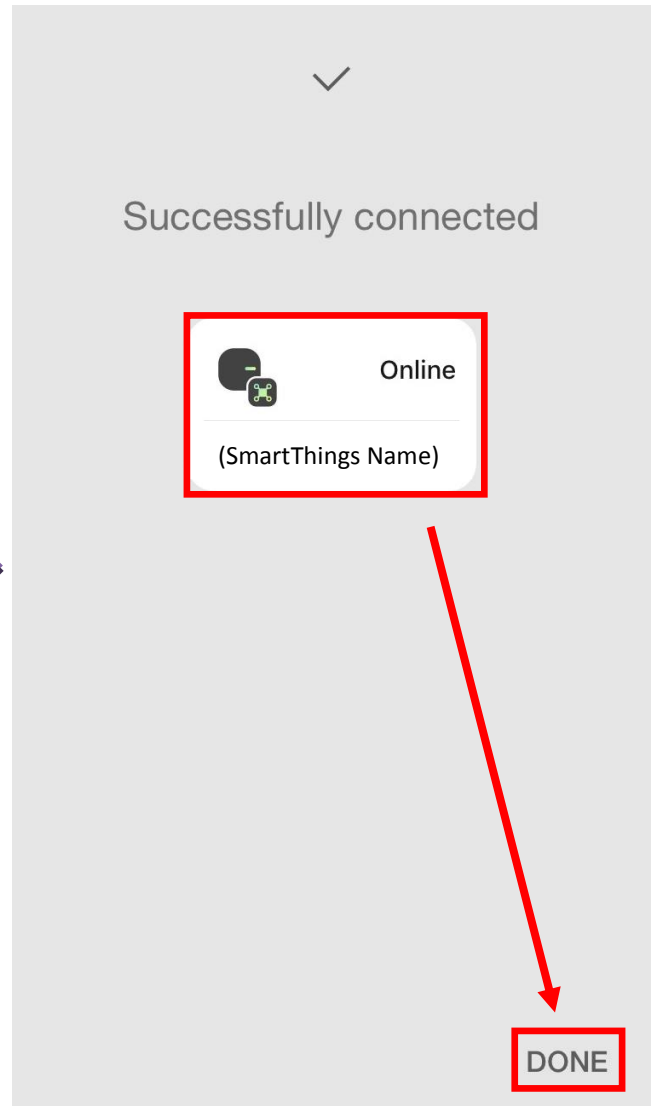

(Image 2.2.18)

3. Add new smart home devices

Different devices require different set-up procedures. The app will provide instructions every time you add a device. The following example describes how to set up and control two devices:

- Go to section 3.1 to find out how to set up the SmartThings motion sensor and Aurora Smart Bulb
- Go to section 3.2 to find out how to control the Aurora Smart Bulb and Samsung motion sensor

3.1. Add the SmartThings motion sensor and Aurora Smart Bulb

Please keep the new devices close to the SmartThings Wifi when setting them up:

- Click “+” on the main page (Image 3.1.1)
- Select “Add device” in the pop-up list (Image 3.1.2)

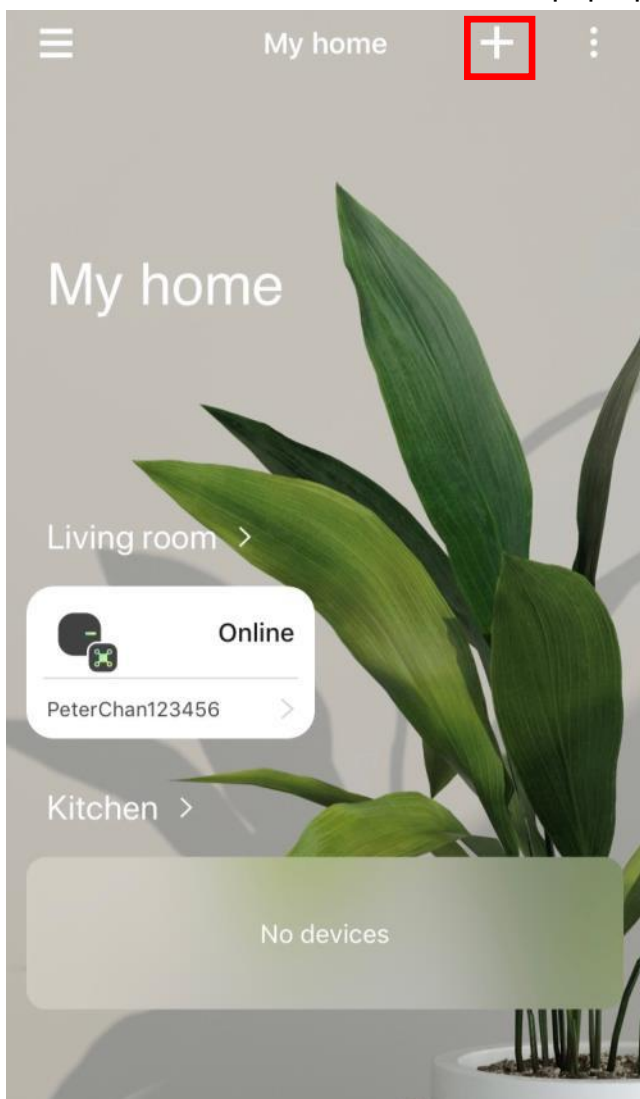

(Image 3.1.1)

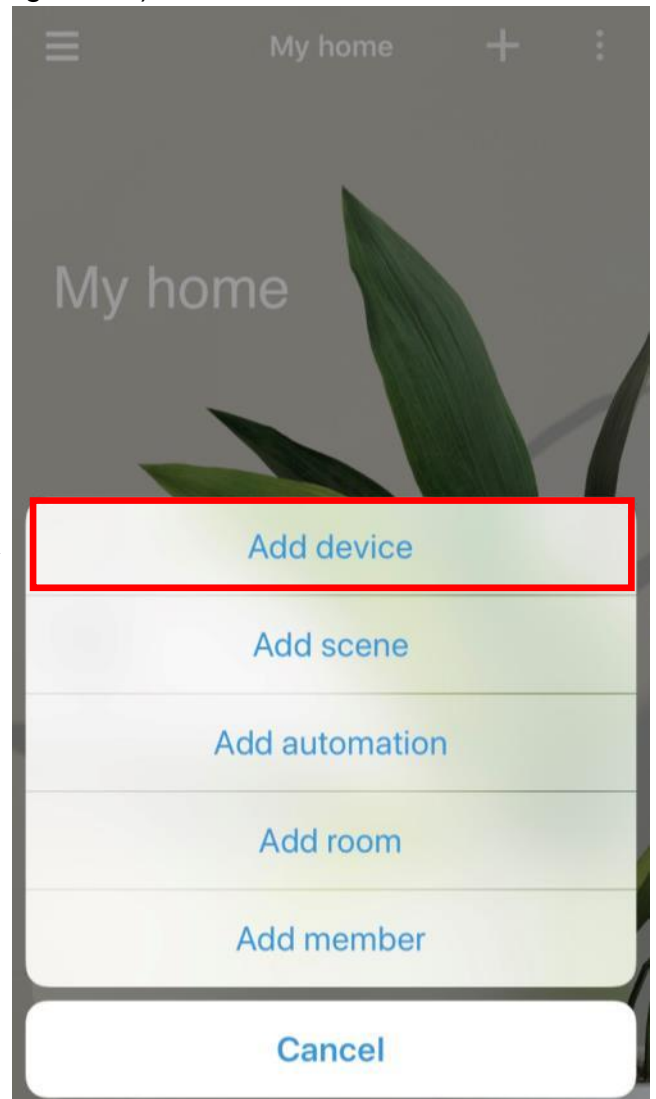

(Image 3.1.2)

How to add the SmartThings motion sensor

- Select “SmartThings” under “All brands” (Image 3.1.3)
- Select “Motion Sensor” (Image 3.1.4)

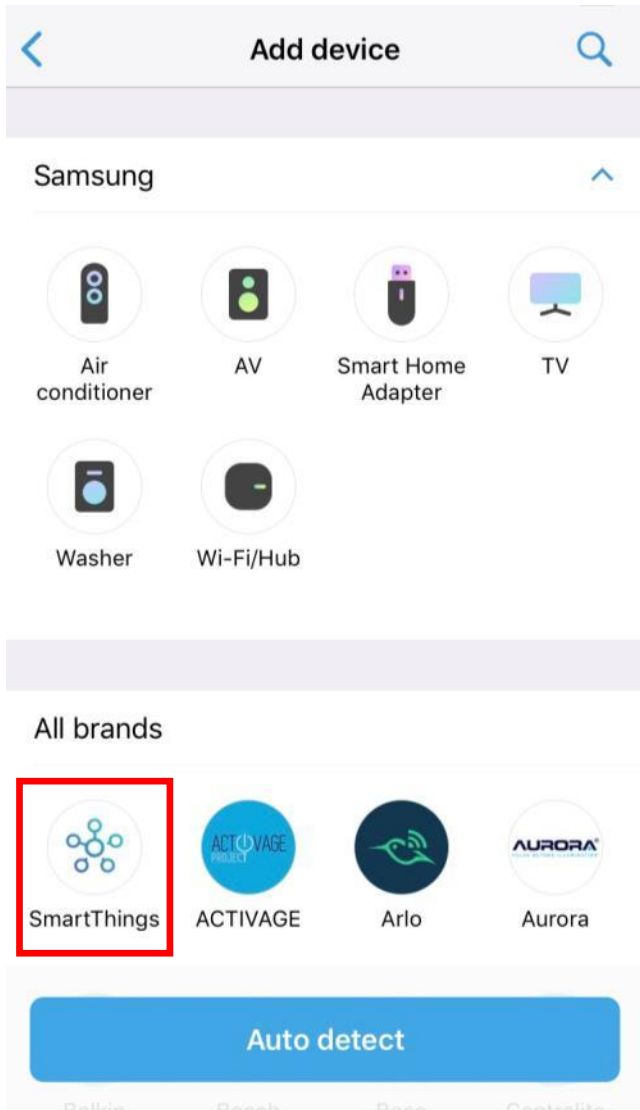

(Image 3.1.3)

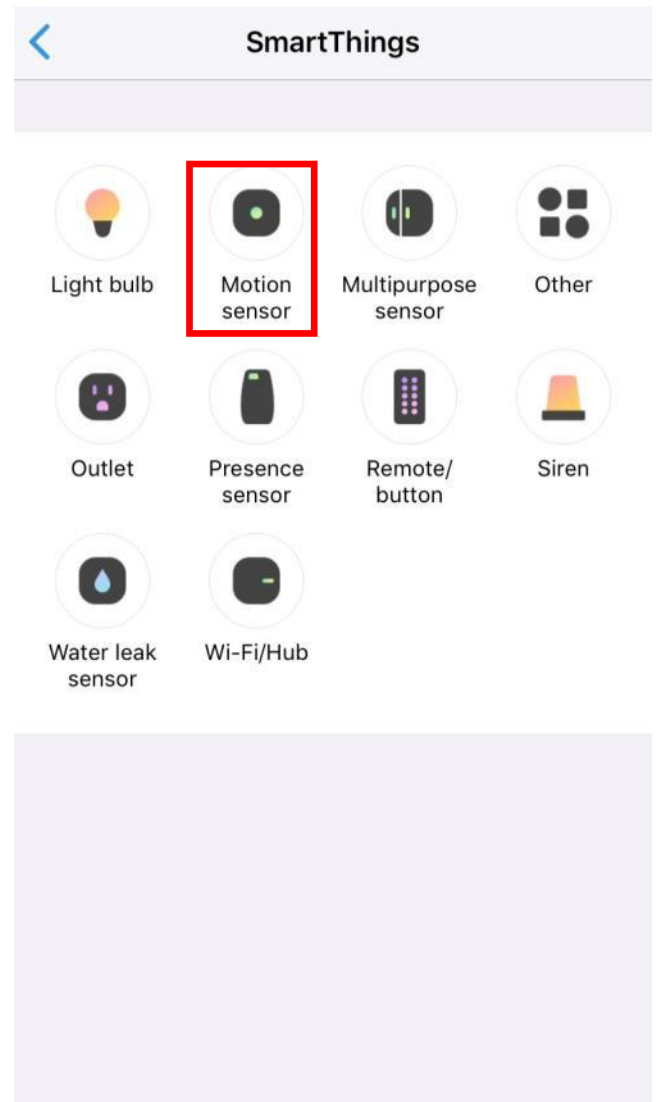

(Image 3.1.4)

- Select “SmartThings (IM6001-MTP)” (Image 3.1.5)
- Select your location, then “Next” (Image 3.1.6)

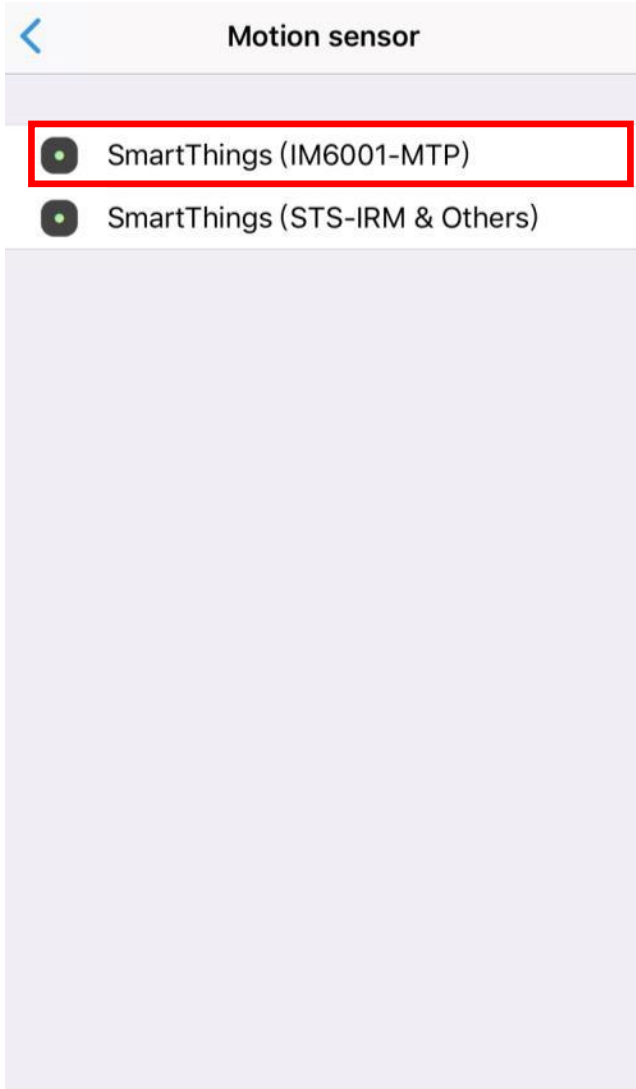

(Image 3.1.5)

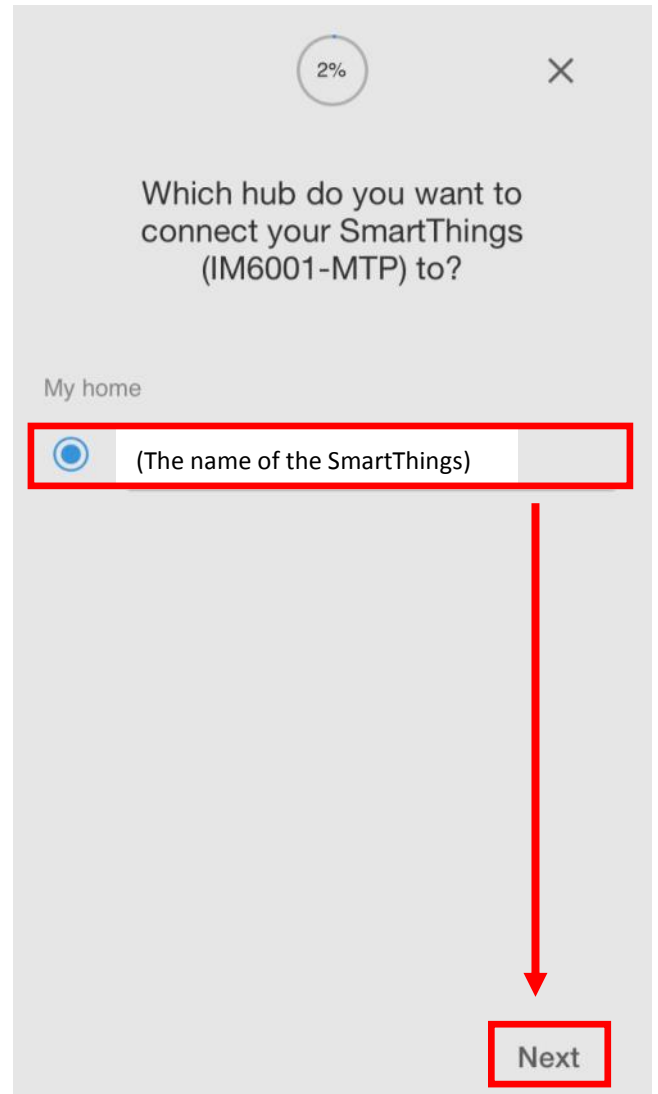

(Image 3.1.6)

- Select the room in which the motion sensor is installed, then select “Next” (Image 3.1.7)
- If the battery tab has removed, it is suggested to select “Learn how to reset your sensor” and follow the instruction to reset the sensor. And then select “Next” (Image 3.1.8)

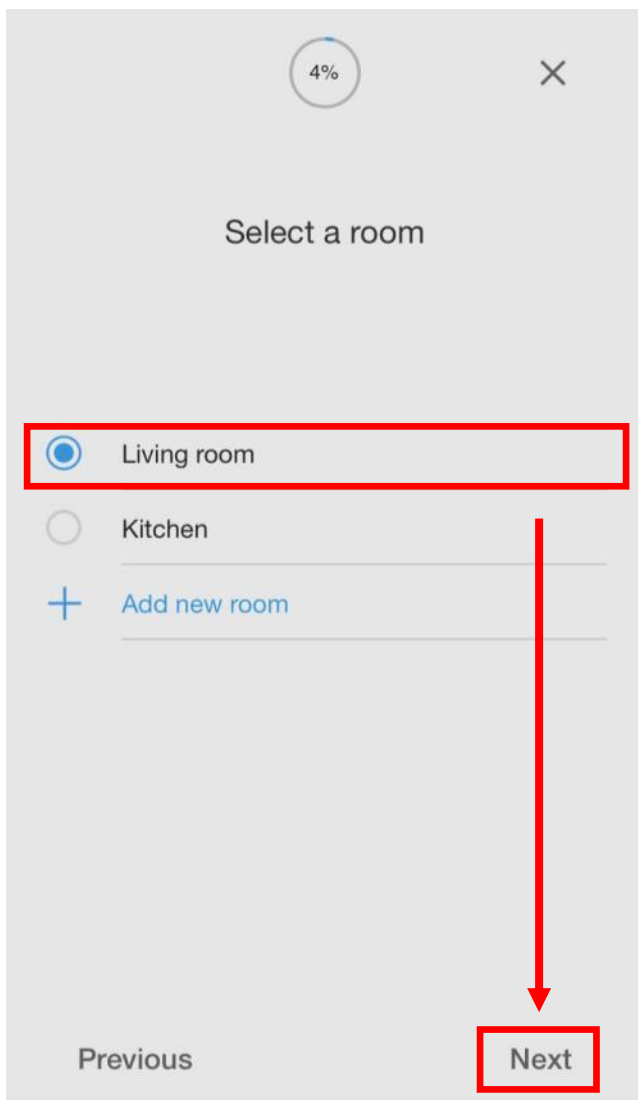

(Image 3.1.7)

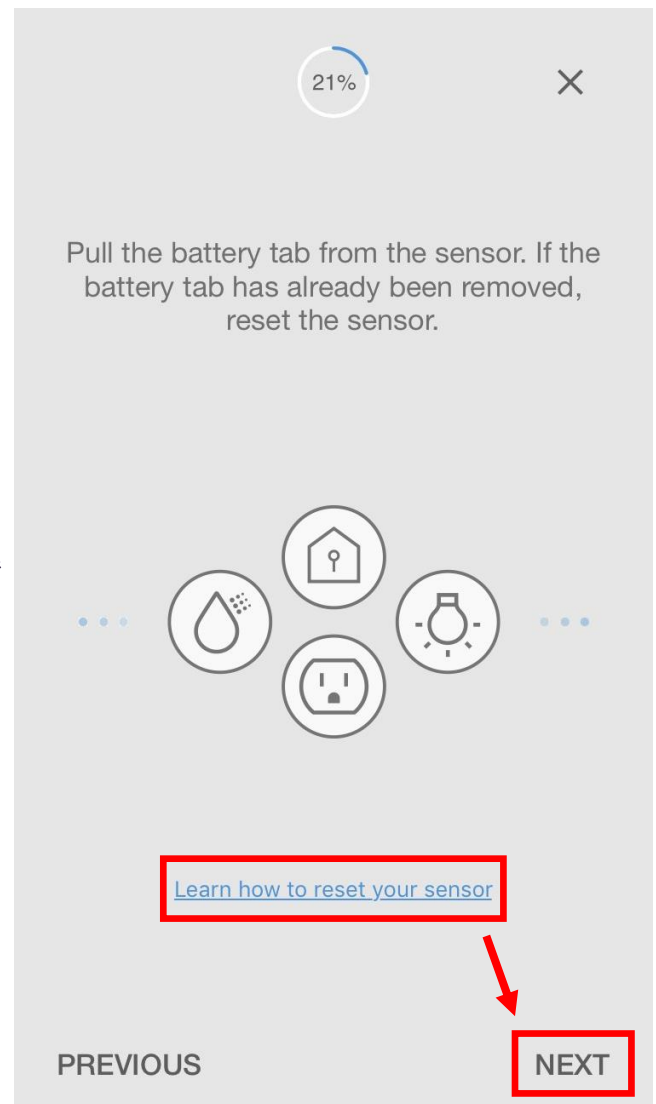

(Image 3.1.8)

- Remove the battery tab and scan the QR code at the bottom of the motion sensor (Image 3.1.9)
- The motion sensor is connected to the system. Select “Motion Sensor” to change the name, or select “Done” to complete the setting (Image 3.1.10)

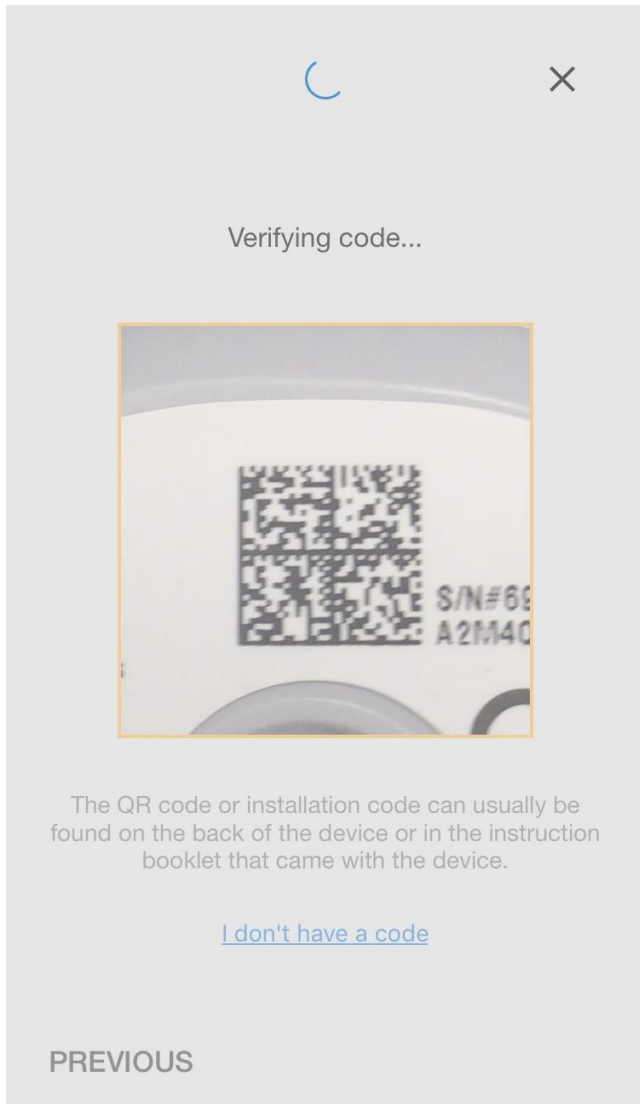

(Image 3.1.9)

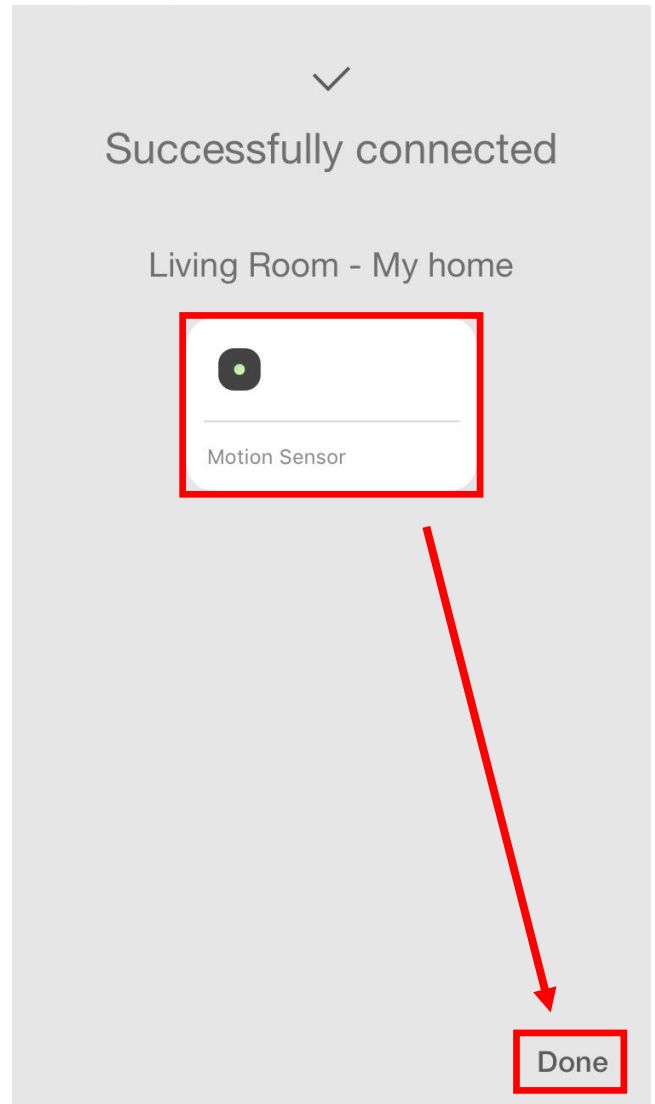

(Image 3.1.10)

How to add the Aurora Smart Bulb

- Select “Aurora” under “Add brands” (Image 3.1.11)
- Select “Light bulb” (Image 3.1.12)

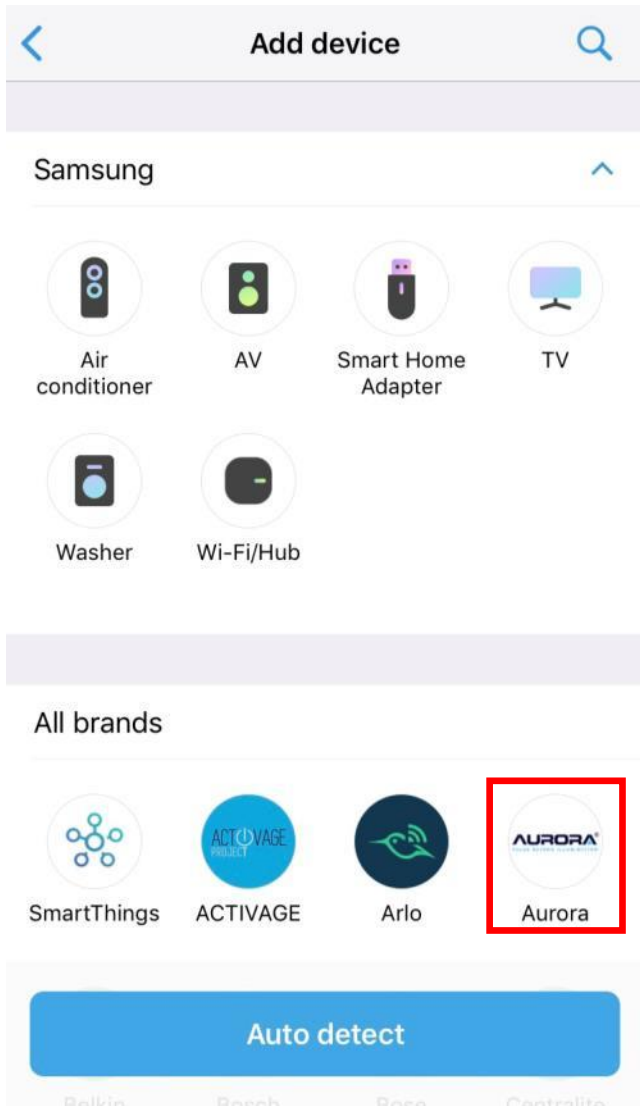

(Image 3.1.11)

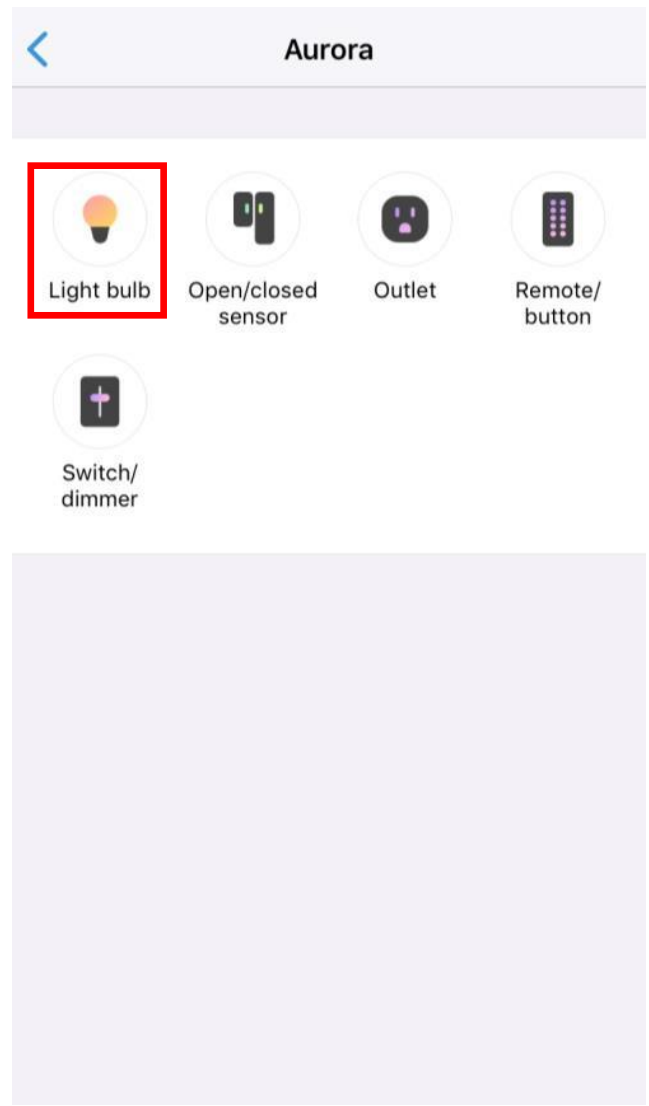

(Image 3.1.12)

- Select your location, then click "Next" (Image 3.1.13)
- Select the room in which the bulb is installed, then click "Next" (Image 3.1.14)

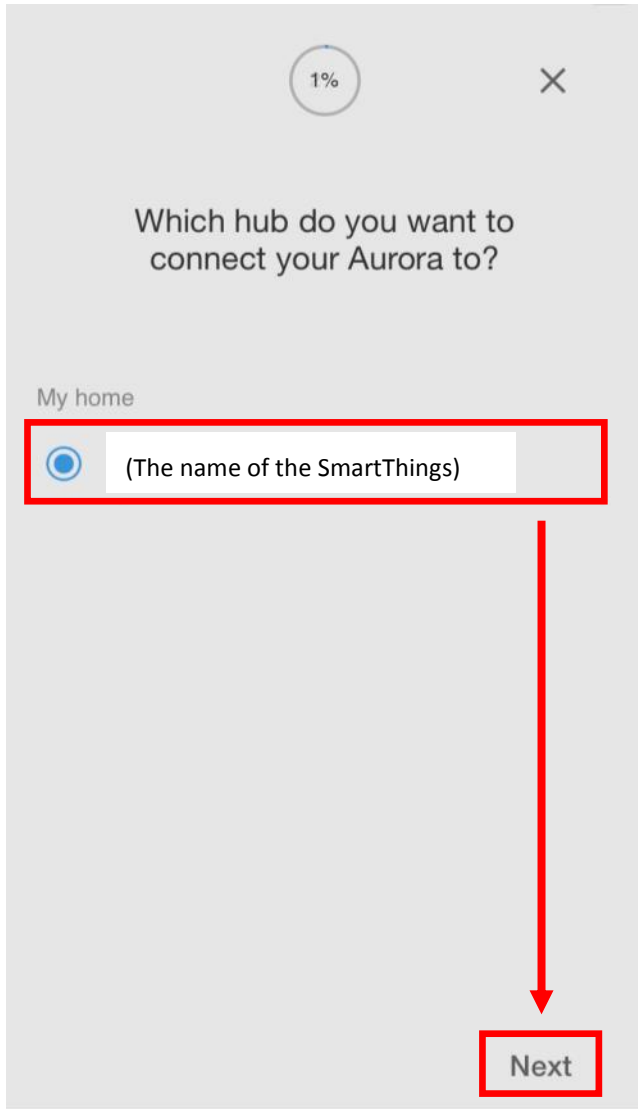

(Image 3.1.13)

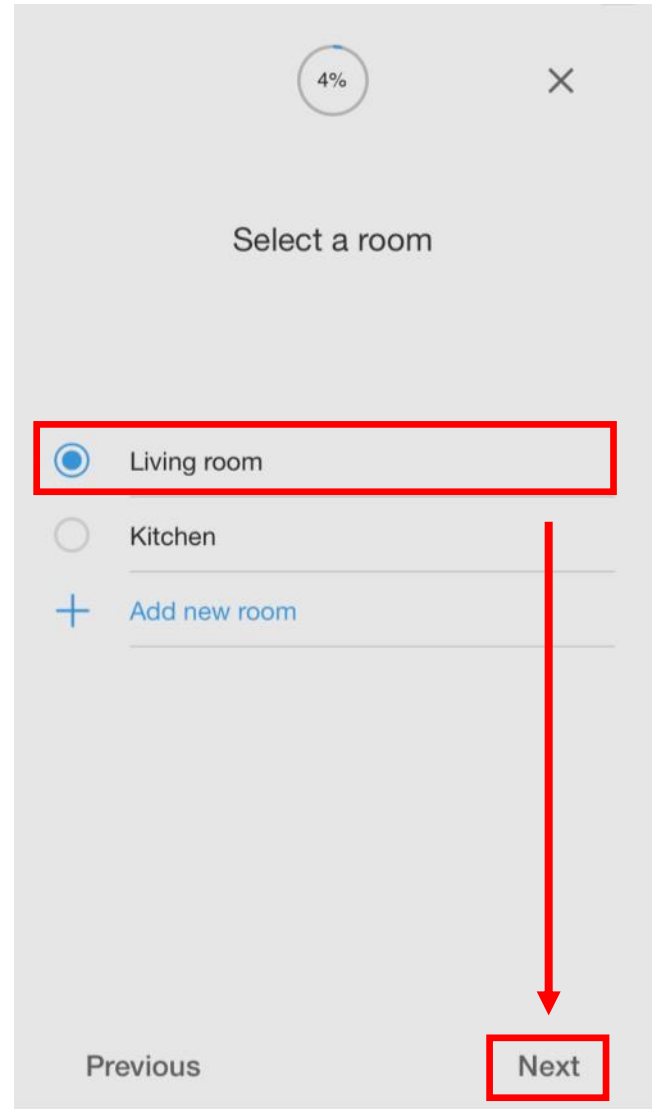
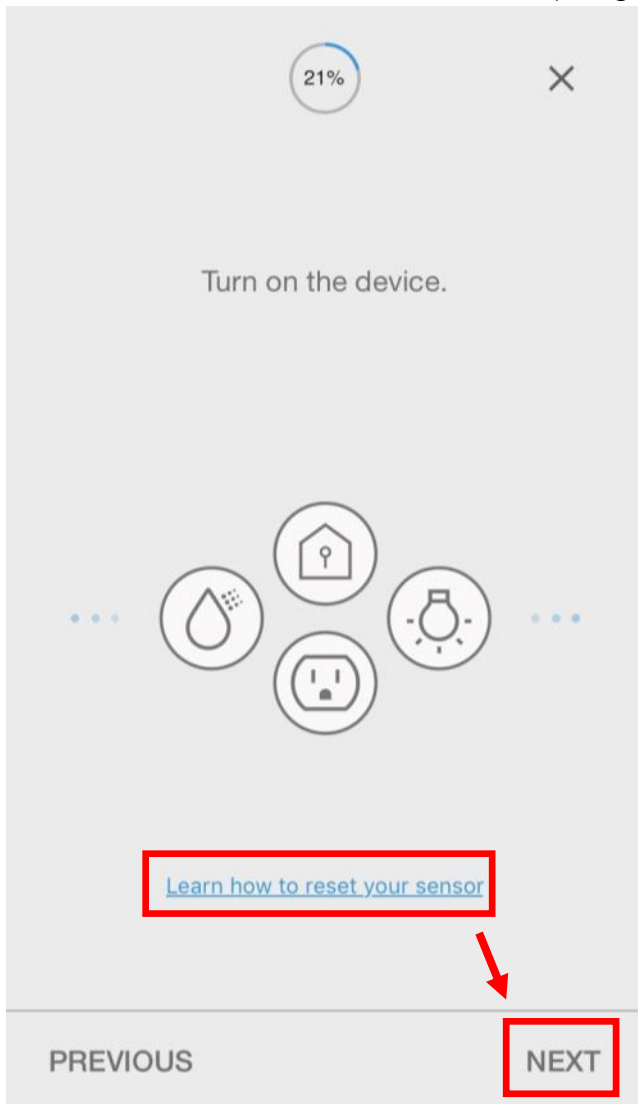
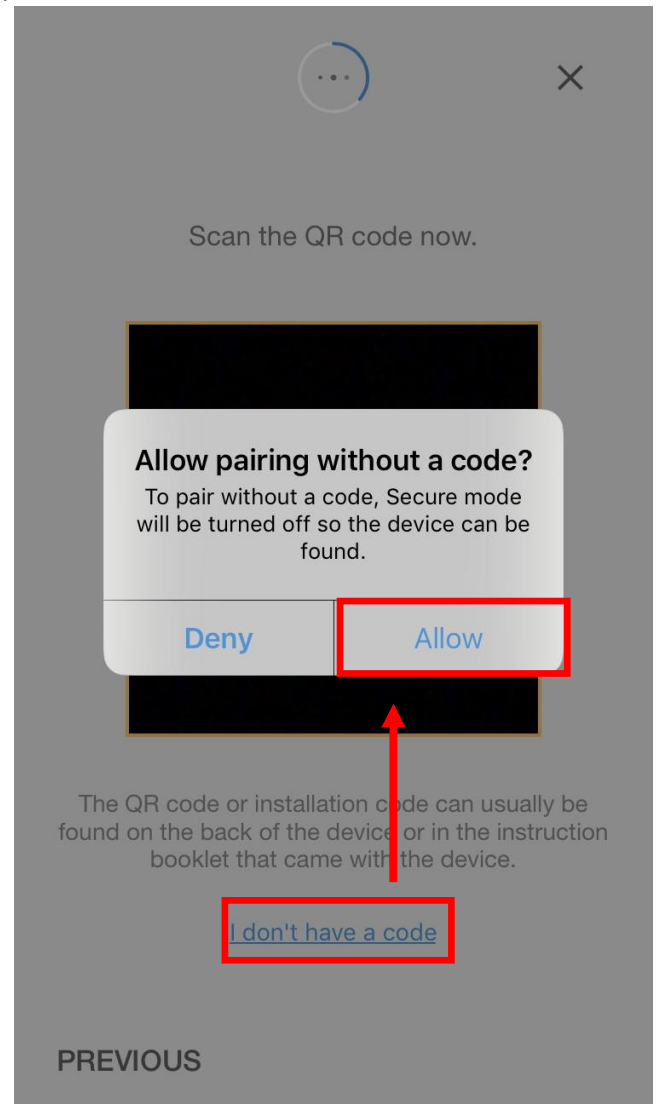

Image 3.1.14)

- If the light bulb has used, it is suggested to select “Learn how to reset your sensor” and follow the instruction to reset the light bulb. And then turn on the bulb, and select “NEXT”. (Image 3.1.15)
- Scan the QR code on the bulb or in the Aurora instruction booklet. If you can't find the QR code, please click “I don't have a code” and click “Allow” to enter auto-pairing mode without a QR code. (Image 3.1.16)



(Image 3.1.15)



(Image 3.1.16)

- The Aurora Smart Bulb is connected to the system. Select “Aurora Lamp” to change the name of the bulb, or select “Done” to complete the setting (Image 3.1.17)

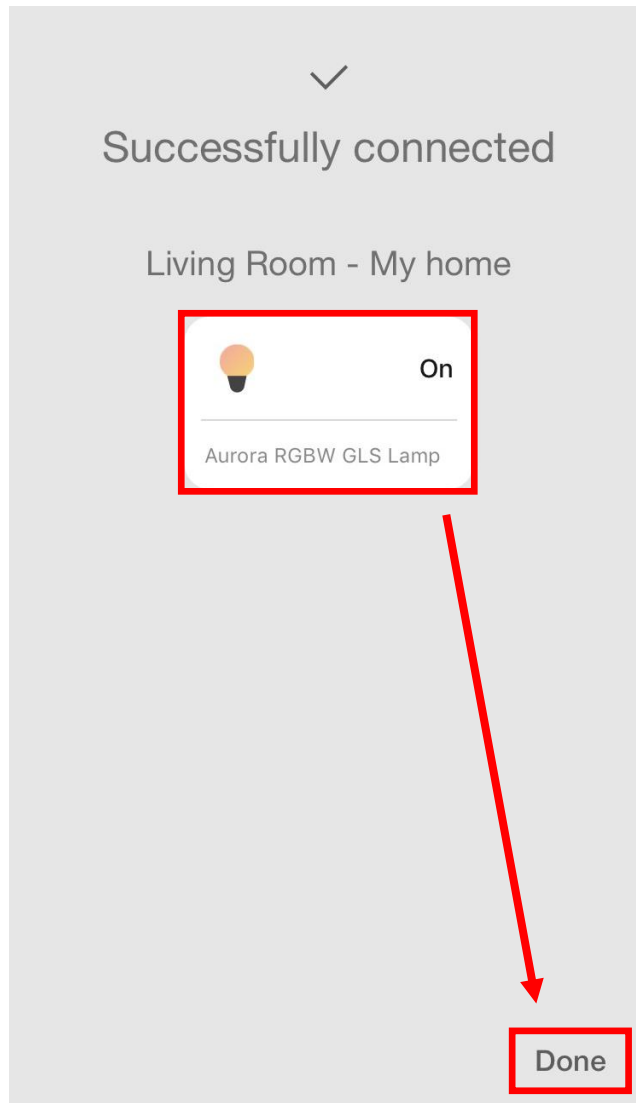

(Image 3.1.17)

3.2. Control Aurora Smart Bulb and motion sensor

The SmartThings app displays a different control page for each device. Examples:

- Image 3.2.1 shows the SmartThings motion sensor control page
- Image 3.2.2 shows the Aurora Smart Bulb control page

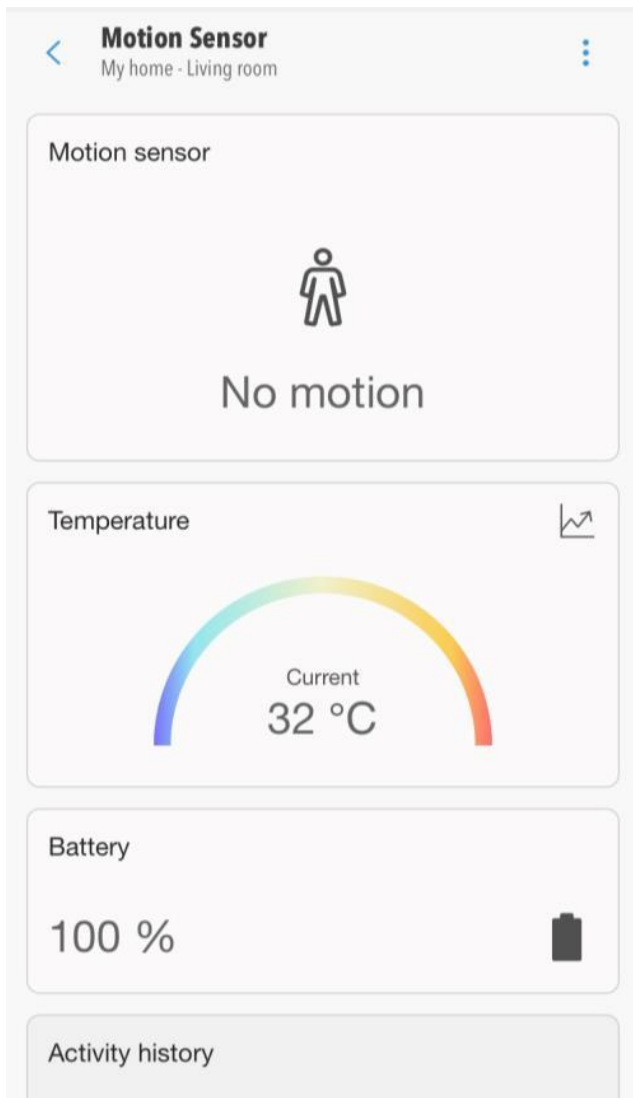

(Image 3.2.1)

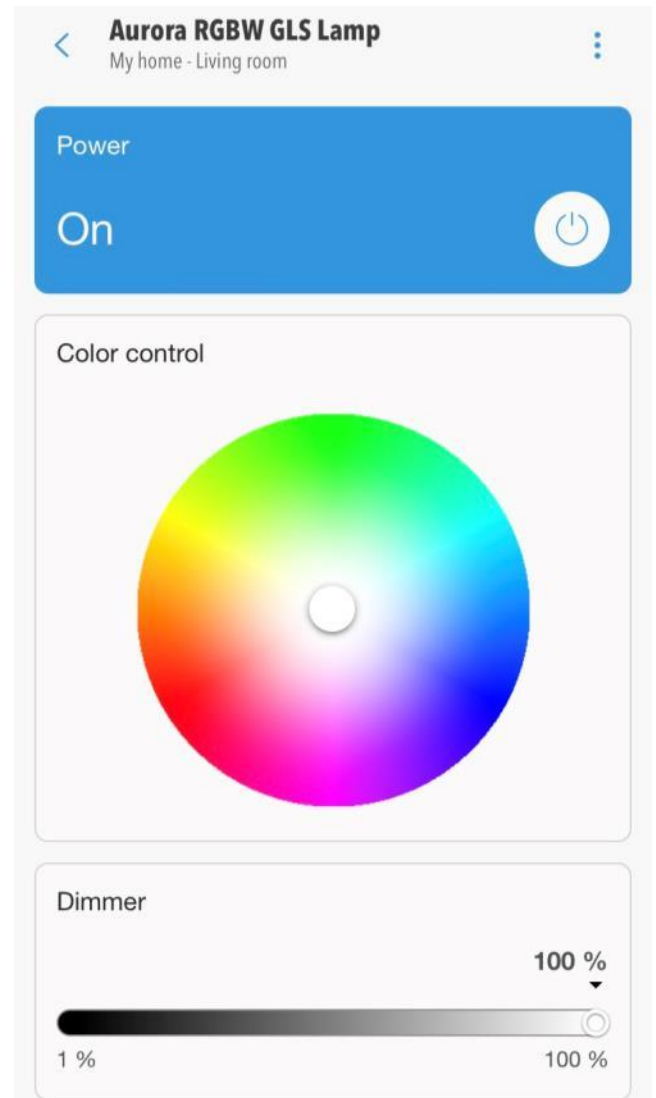

(Image 3.2.2)

4. Set up your smart home

- Go to section 4.1 to find out how to create an ambient scene
- Go to section 4.2 to find out how to automate

4.1. Create an ambient scene

You can create your own ambient scene using connected devices in the SmartThings Wifi. The procedure follows:

- Select “+” on the main page (Image 4.1.1)
- Select “Add scene” on the pop-up page (Image 4.1.2)

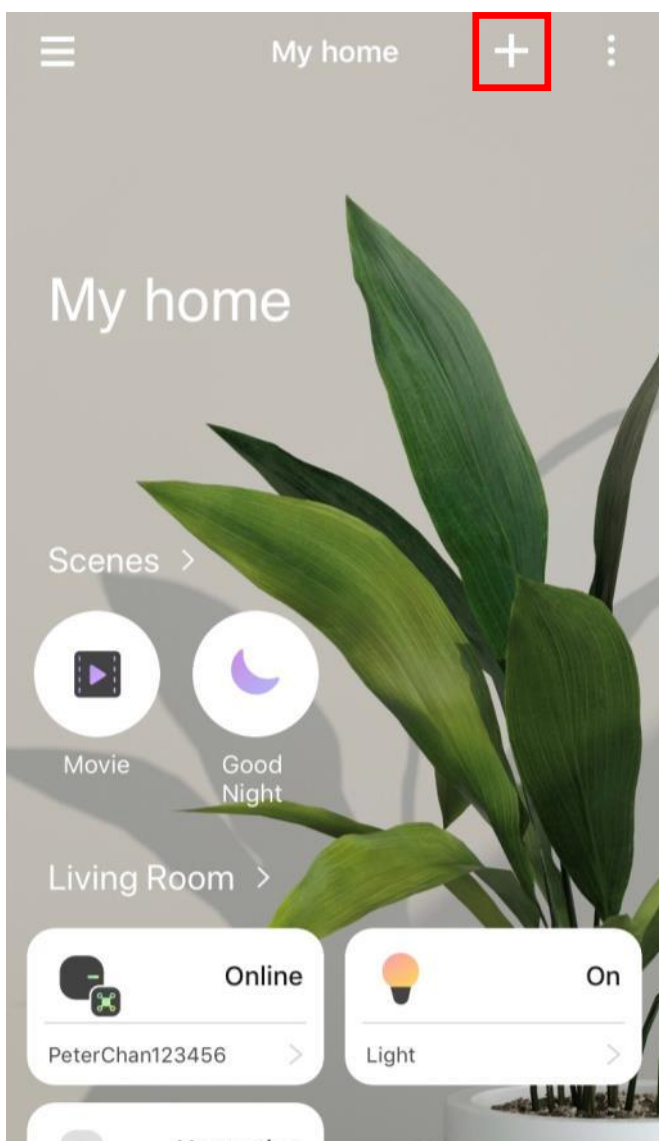

(Image 4.1.1)

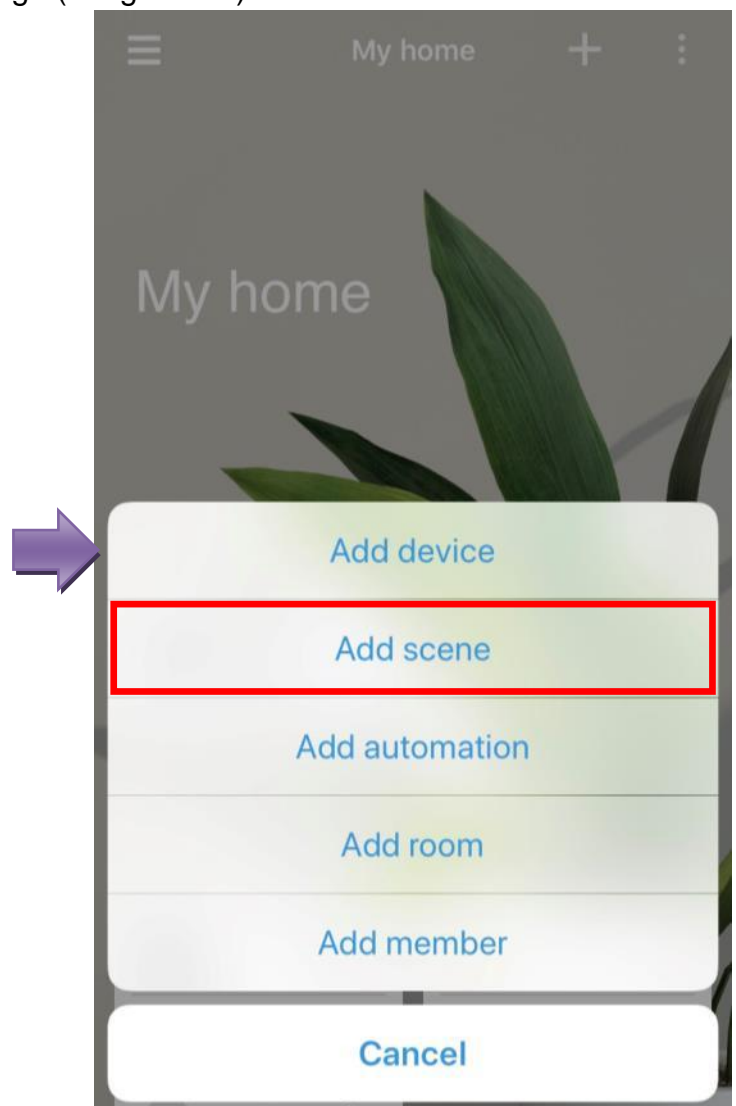

(Image 4.1.2)

- Enter a name for the ambient scene and select an icon, then select “Add action” (Image 4.1.3)
- Select “Control devices” (Image 4.1.4)

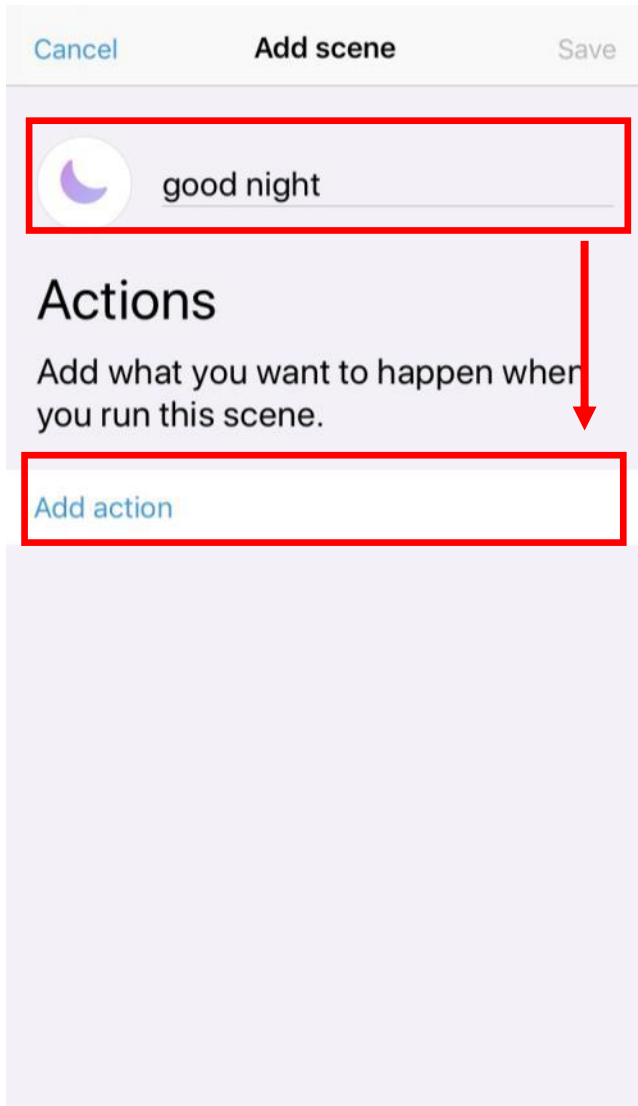

(Image 4.1.3)

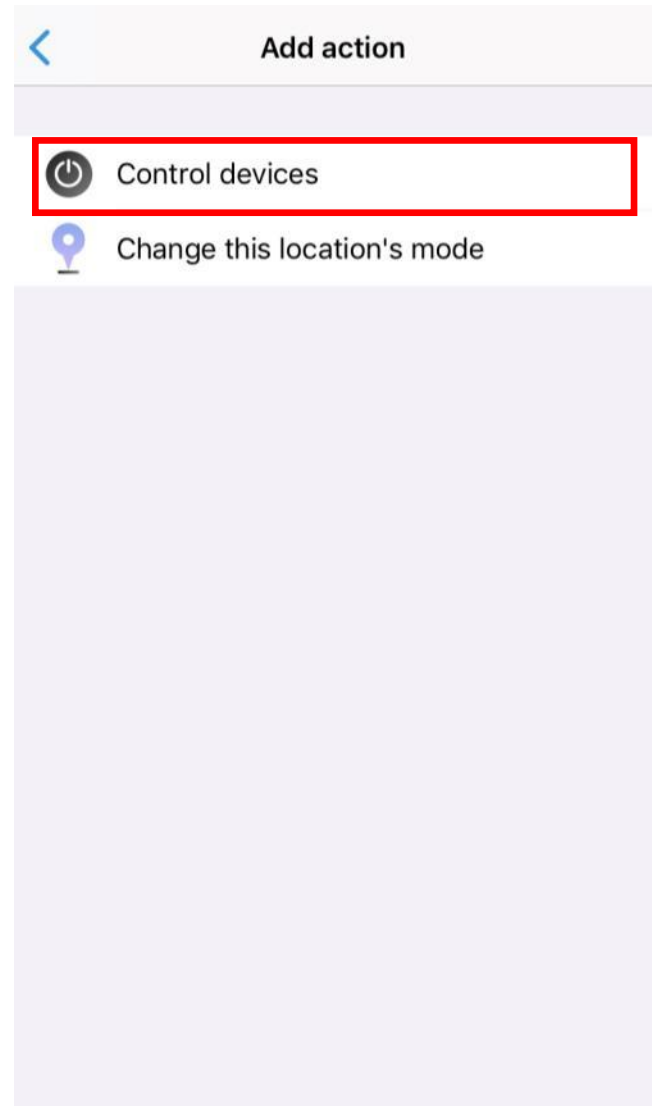

(Image 4.1.4)

- Select the devices to be activated to create the ambient scene, then select “Next” (Image 4.1.5)
- Tune the status of each device in this scene. Click “Test” to run the scene setting operation (Image 4.1.6)

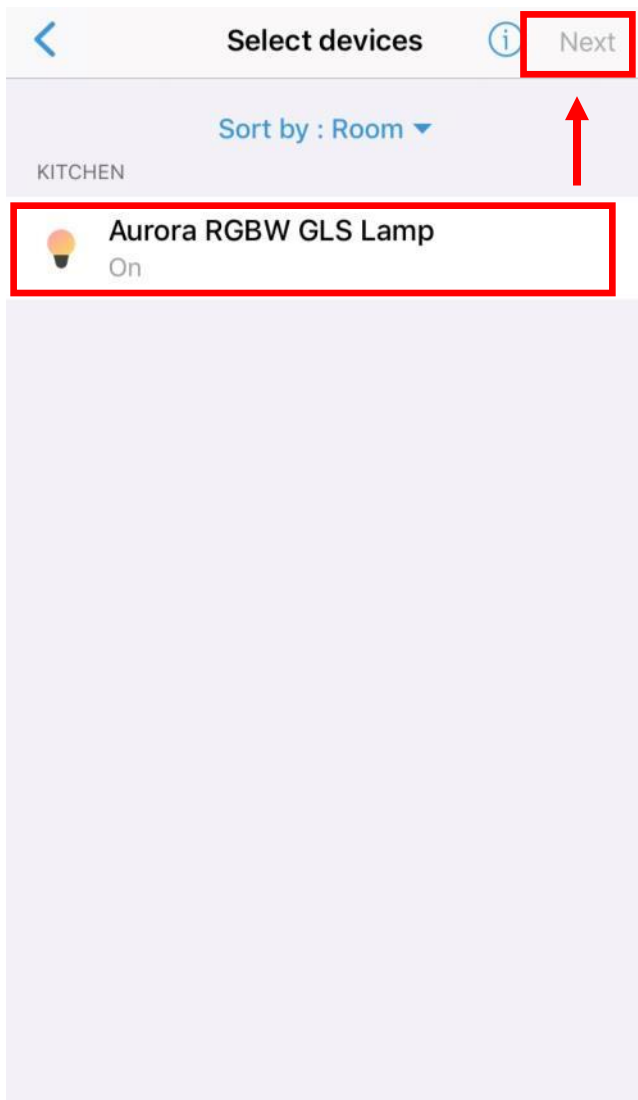

(Image 4.1.5)

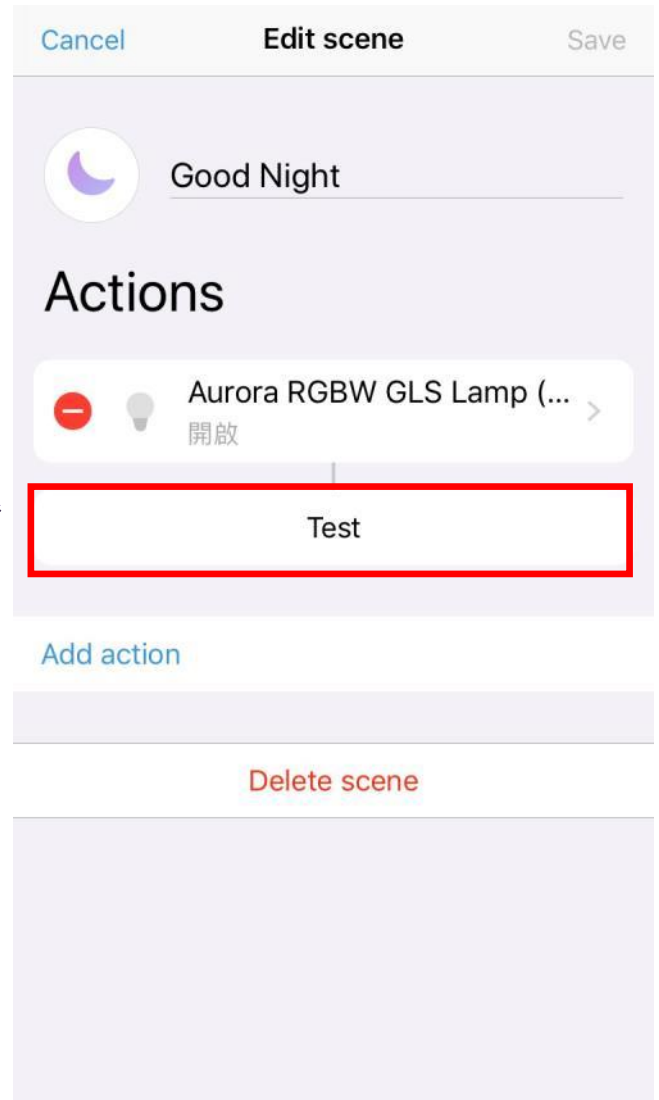

(Image 4.1.6)

- Test complete. Select “Save” (Image 4.1.7)

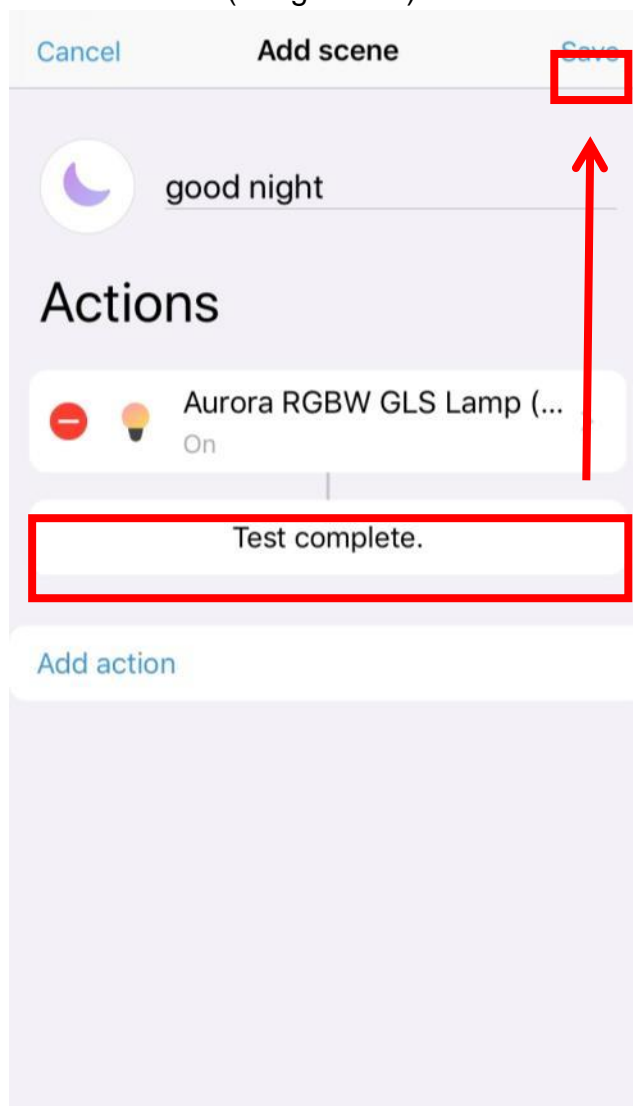

(Image 4.1.7)

4.2. Set up automation

The SmartThings Wifi will turn on some devices automatically. For example, once motion is detected, preset lights will be switched on automatically. Set up procedure follows:

- Select “+” on the main page (Image 4.2.1)
- Select “Add automation” on the pop-up page (Image 4.2.2)

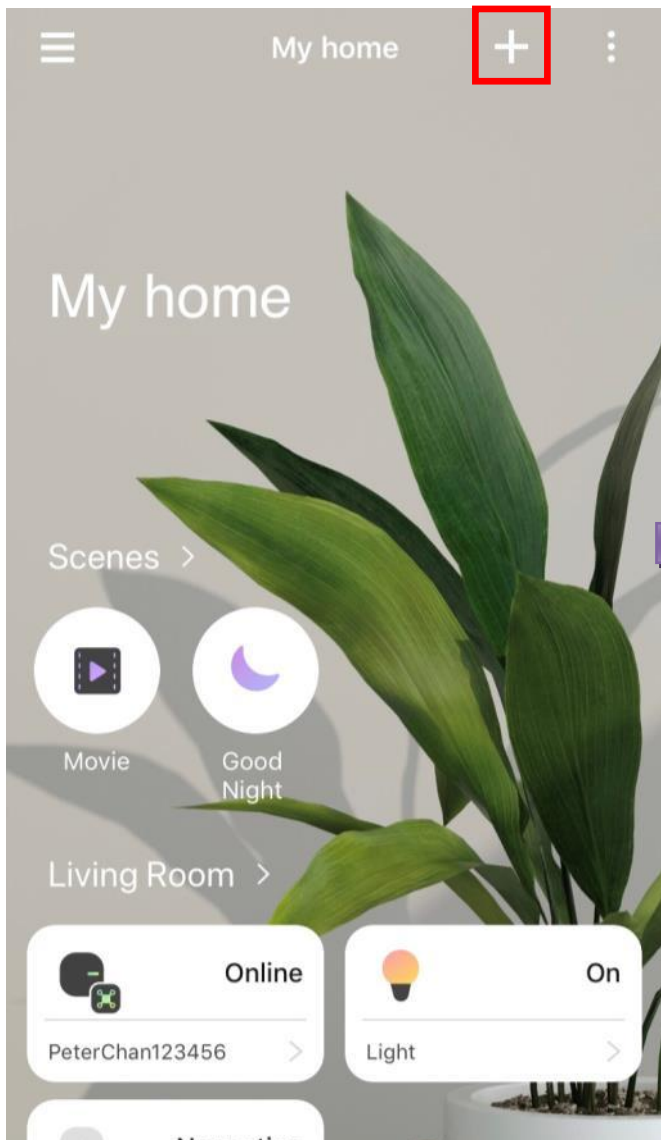

(Image 4.2.1)

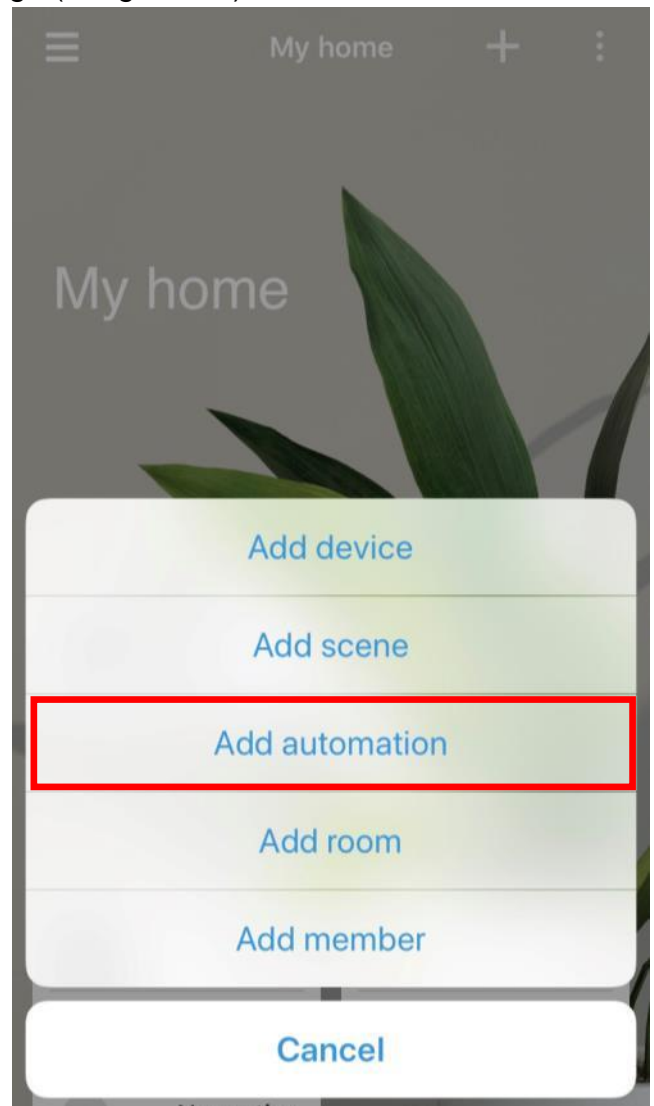

(Image 4.2.2)

User needs to set the condition and action that will activate a preset ambient scene

- Select “Add condition” (Image 4.2.3)
- Select “Device status” (Image 4.2.4)

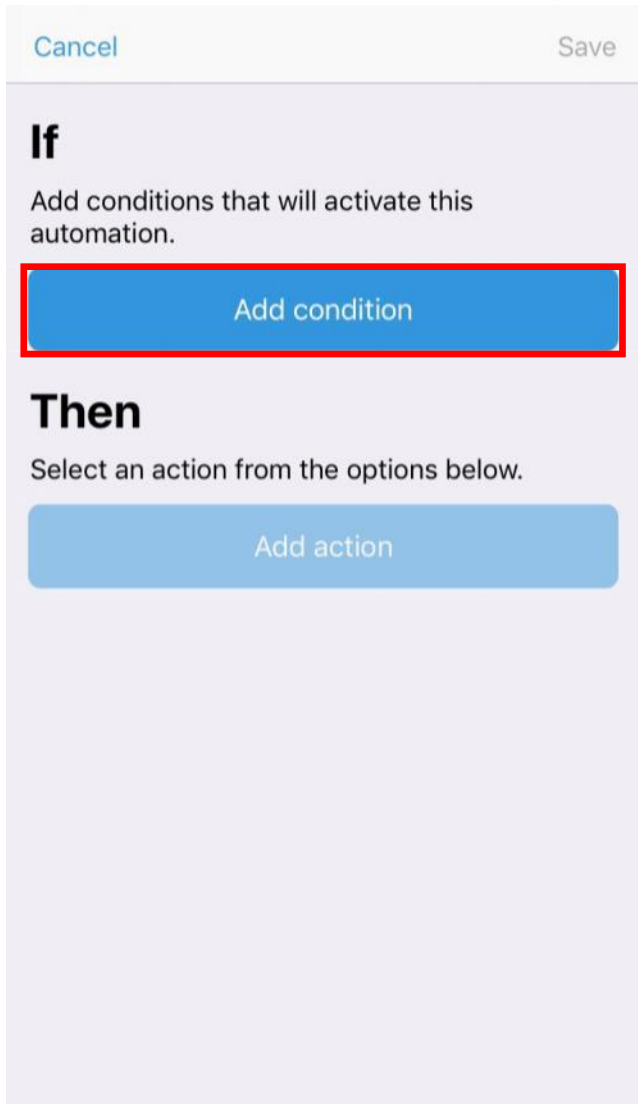

(Image 4.2.3)

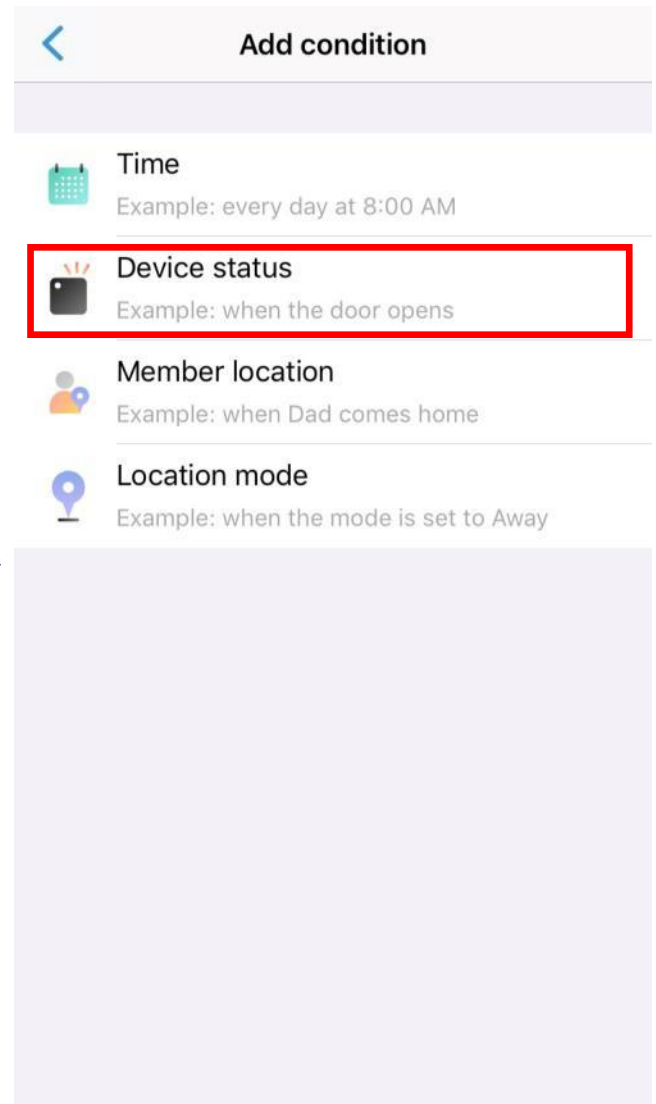

(Image 4.2.4)

- Select the motion sensor setting, then select “Next” (Image 4.2.5)
- Choose “Motion detected”, then select “Done” (Image 4.2.6)

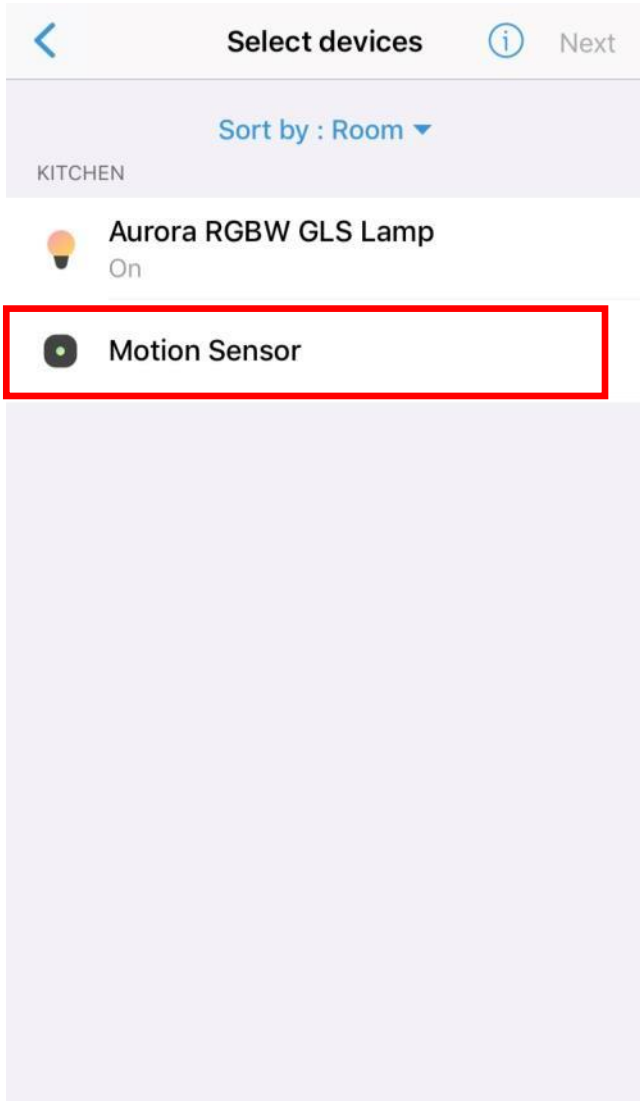

(Image 4.2.5)

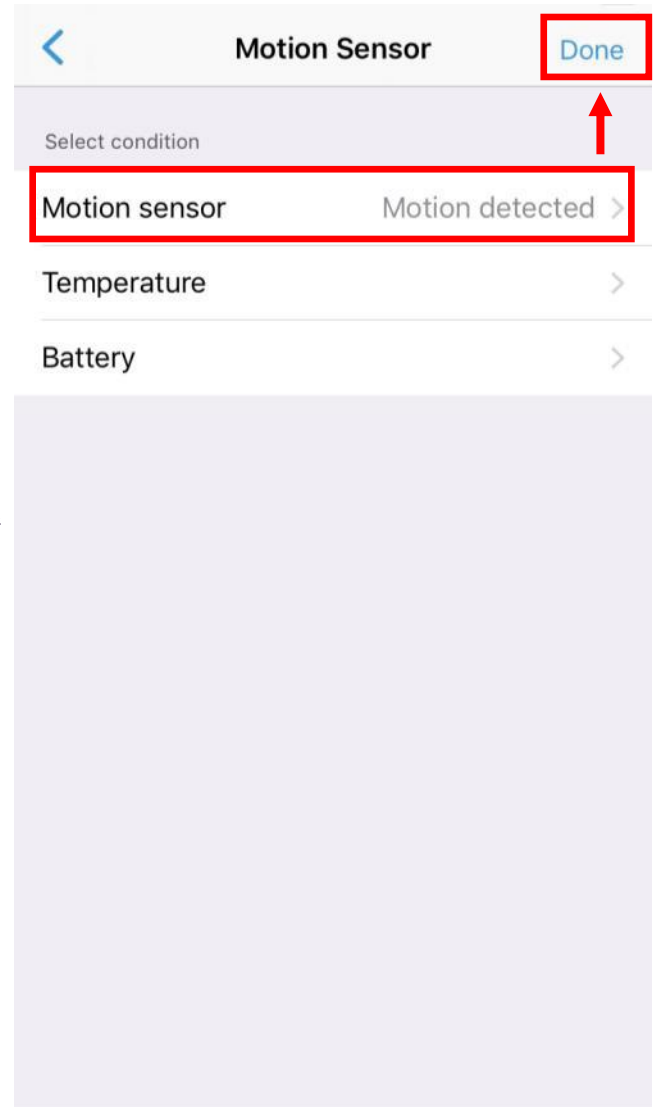

(Image 4.2.6)

- Select “Add action” (Image 4.2.7)
- Select “Control devices” (Image 4.2.8)

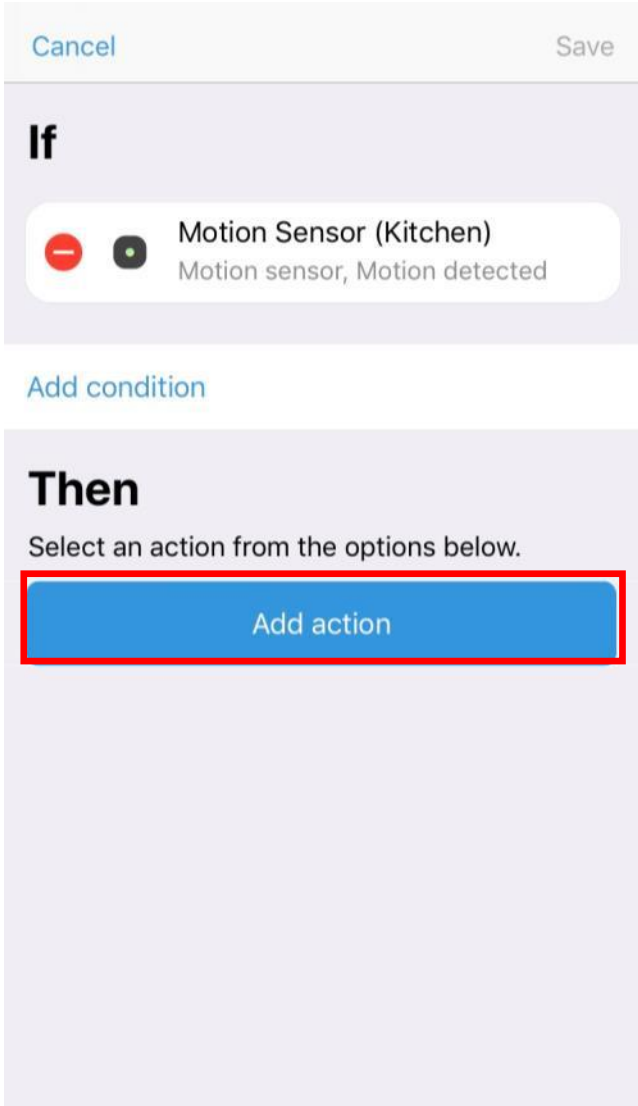

(Image 4.2.7)

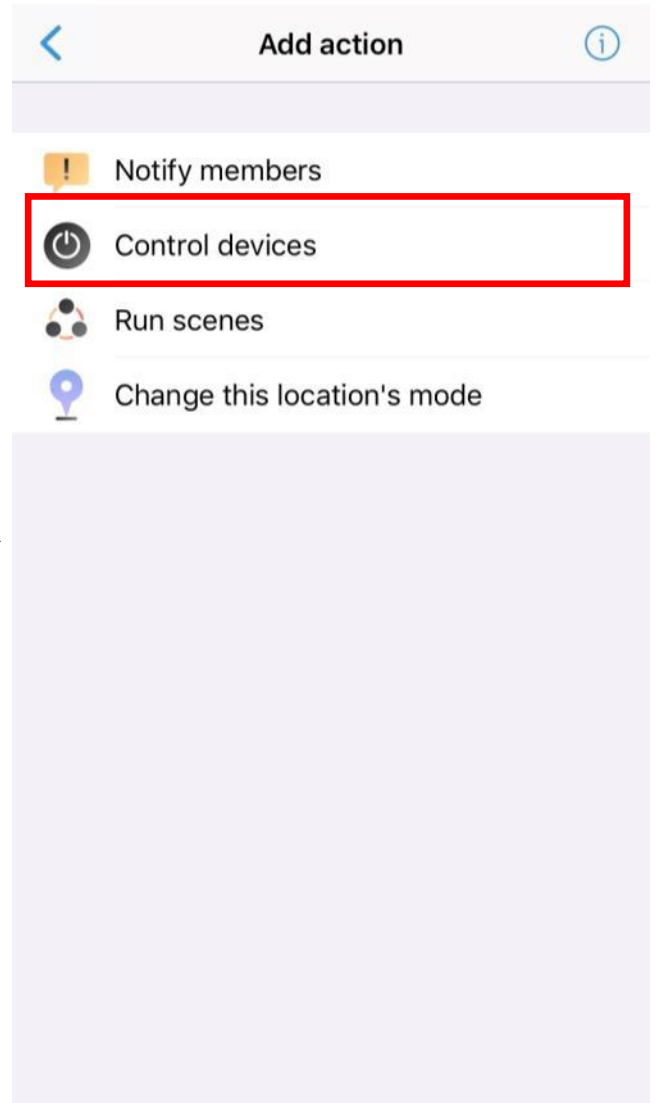

(Image 4.2.8)

- Select the Aurora Smart Bulb setting, then select “Next” (Image 4.2.9)
- Select “Save” (Image 4.2.10)

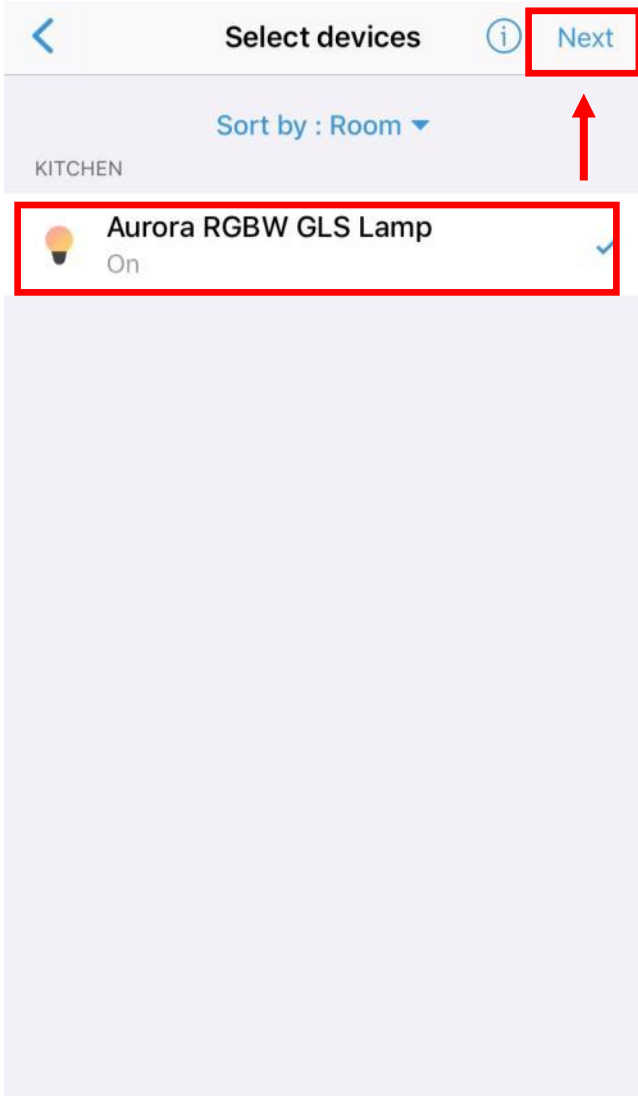

(Image 4.2.9)

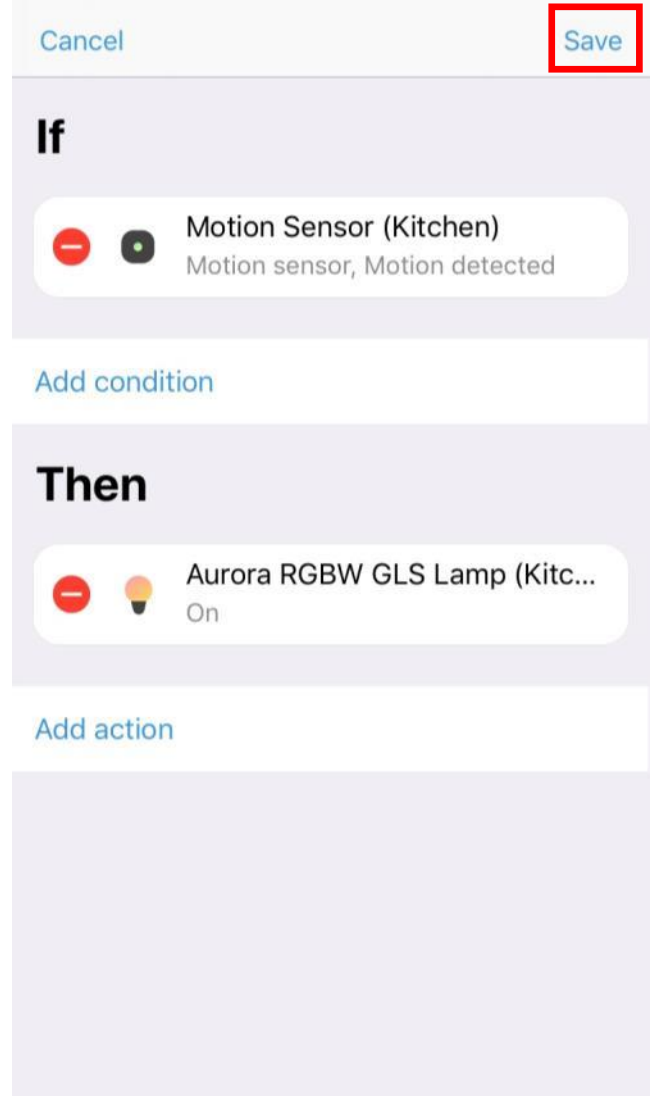

(Image 4.2.10)

- Enter the name in “Automation name” and click “OK” (Image 4.2.11)
- User can enable/disable automation via a button (Image 4.2.12)

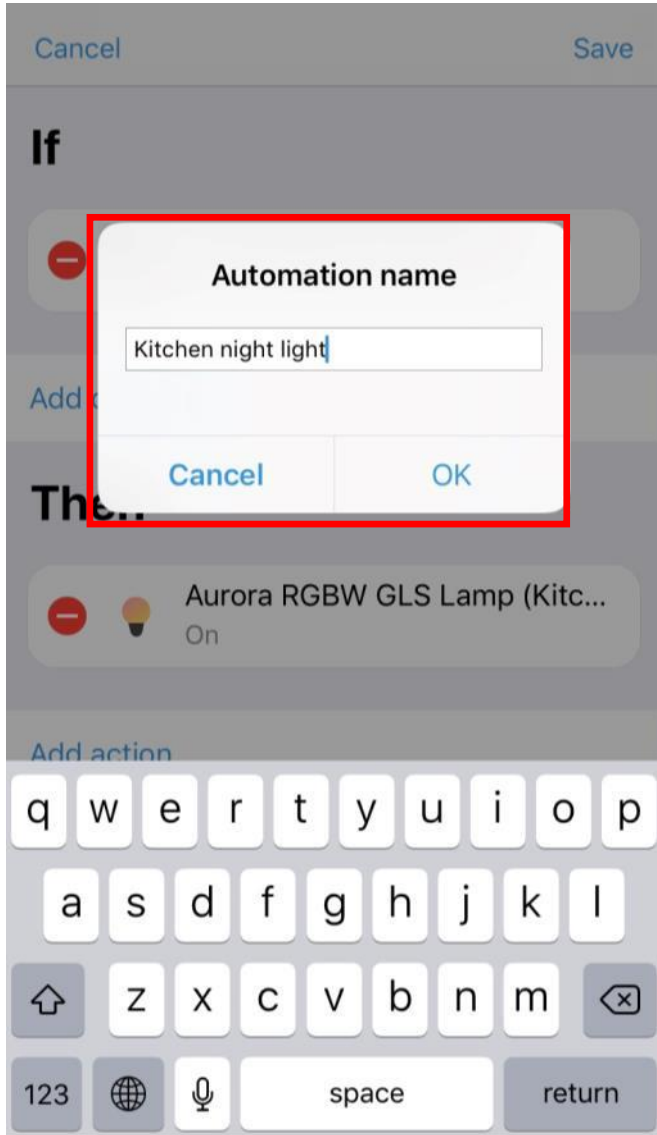

(Image 4.2.11)

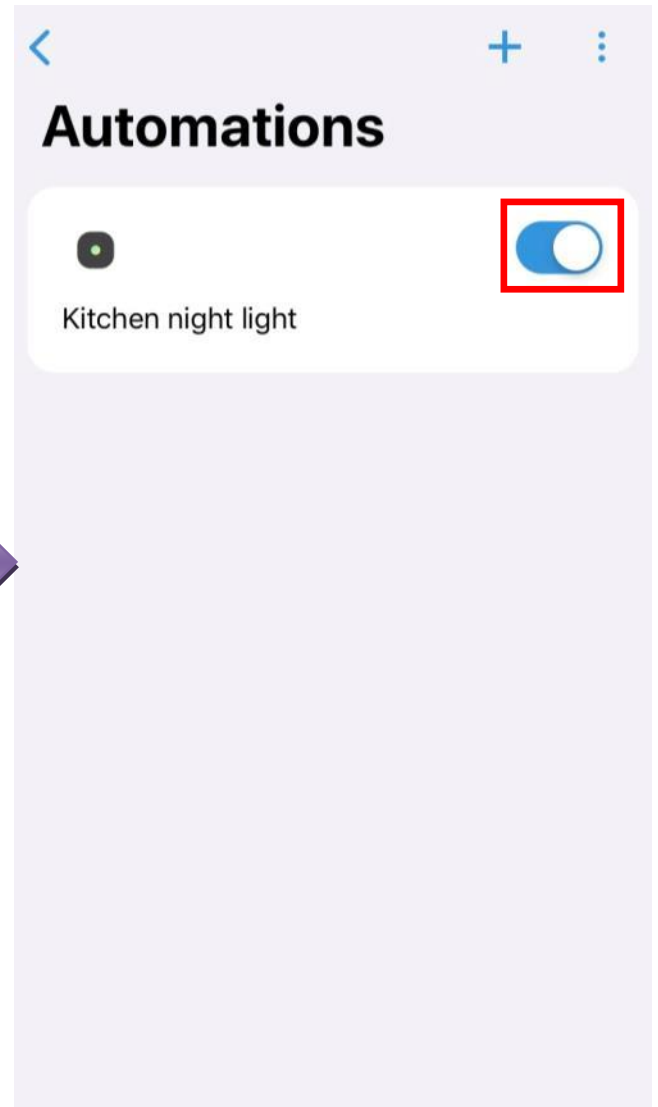

(Image 4.2.12)

HKT Smart Living customer service

Hotline: 1000 (select language, then press 5, then press 5 again)

Email: enquiry@smartliving.hkt.com

End